

AMENDMENT NO. 1

TO

PART 1 CONTRACT FOR DESIGN-BUILD SERVICES

This AMENDMENT No. 1 is to the Contract for design-build services which was entered into the 7th day of June, 2018 by and between the Hillsborough County Aviation Authority, a public body corporate under the laws of the State of Florida, hereinafter referred to as the "Owner", and Hensel Phelps Construction Co., a Colorado Corporation, authorized to do business in the State of Florida, hereinafter referred to as the "Design-Builder". With the execution of Amendment No. 1, the Owner and the Design-Builder, for the consideration stated herein, and other good and valuable consideration, hereto agree to change provisions of the aforementioned Contract as follows:

1. ARTICLE 1 – DESIGN-BUILDER

Delete Paragraph 1.2.1 in its entirety and replace with the following:

1.2.1 The services that the Design-Builder will provide to the Owner under this Contract will be as follows, and in general accordance with the Owner's Request for Qualifications dated October 4, 2017, entitled "Request for Qualifications for Main Terminal Curbside Expansion, New Energy Plant and Related Work at Tampa International Airport", and the Design-Builder's fee and scope proposal dated May 25, 2018, entitled "Part 1 Agreement Proposal-Final, Authority Project Nos. Project Nos. 8200 18, 8205 18, 8900 18, 8230 18 and 8310 19, Main Terminal Curbside Expansion," which are incorporated by reference herein, and the Design-Builder's fee and scope proposals dated May 21, 2019, which are attached hereto as Attachment No. 1 and incorporated by reference herein. In the event of any conflicts between this Contract and any other documents, the precedence in resolving such conflicts will be as follows:

- 1.2.1.1 This Contract
- 1.2.1.2 Design-Builder's fee and scope proposals
- 1.2.1.3 The Owner's Request for Qualifications
- 1.2.1.4 Relevant portions of the Design-Builder's response to Request for Qualifications
- 1.2.1.5 Work orders

2. ARTICLE 9 – BASIS OF COMPENSATION

Delete Paragraph 9.0 in its entirety and replace with the following:

9.0 The Owner will compensate the Design-Builder for services rendered under this Contract, as described in Attachment 1.

The amount for the performance of Basic Services required under this Contract and costs identified as reimbursable expenses will be in a not to exceed amount of Twenty Nine Million Two Hundred Ninety Four Thousand One Hundred Eighty Five and No One Hundredths Dollars (\$29,294,185.00), which includes all fees for subconsultants.

3. ARTICLE 19 – WOMAN AND MINORITY OWNED BUSINESS ENTERPRISE (W/MBE) ASSURANCES

Delete Paragraph 19.3 in its entirety and replace with the following:

19.3 W/MBE Goals. In compliance with the Owner’s W/MBE Policy and Program, the Design-Builder’s minimum W/MBE commitment is established as the sum total of the verified Letter(s) of Intent for each portion of the Program submitted with their response. The W/MBE goal stated below is the sum total of the certified W/MBE’s listed in the Design-Builder’s fee and scope proposal which is attached hereto and which will be enforceable under the terms of this Contract. The Design-Builder will demonstrate that they will subcontract to certified W/MBEs at least 17.0% of the total dollar amount earned on the design phase of the Program.

4. All other consistent terms remain in full force and effect and are hereby ratified and confirmed.
5. The Contract, as modified by Amendment No. 1, represents the entire understanding between the parties on the issues contained in the Contract, either written or oral, and may be amended only by written instrument signed by both parties.

IN WITNESS WHEREOF, the parties hereto have set their hands and corporate seals by their proper officers, duly authorized to do so;

By the Design Professional this _____ day of _____, 2019.

ATTEST:

Hensel Phelps Construction Co.

By: _____

Title: _____

Print Name

(Affix Corporate Seal)

Print Address

Signed, sealed, and delivered in the presence of:

Witness

Print Name

Witness

Print Name

Notary for Hensel Phelps Construction Co.

STATE OF _____

COUNTY OF _____

The foregoing instrument was acknowledged before me this ____ day of _____, 2019, by _____ in the capacity of _____, of Hensel Phelps Construction Co., on its behalf. (He is / She is)(Personally known to me /not personally known to me) and has produced the following document of identification _____, and (they / he / she) (did / did not) take an oath.

(Seal of Notary)

Signature of Notary

Print, or type Name of Notary

By the Authority this 6th day of June, 2019.

HILLSBOROUGH COUNTY AVIATION AUTHORITY

(Affix Corporate Seal)

By: _____
Robert I. Watkins, Chairman

ATTEST:

Lesley "Les" Miller, Jr, Secretary

Signed, sealed, and delivered
in the presence of:

Witness

Print Name

Witness

Print Name

**APPROVED AS TO FORM FOR LEGAL
SUFFICIENCY:**

By: _____
Michael Kamprath, Assistant General Counsel

Notary for Hillsborough County Aviation Authority

**STATE OF FLORIDA
COUNTY OF HILLSBOROUGH**

The foregoing instrument was acknowledged before me this ____ day of _____, 2019, by Robert I. Watkins, in the capacity of Chairman, and by Lesley "Les" Miller, Jr. in the capacity of Secretary, Hillsborough County Aviation Authority, an independent special district under the laws of the State of Florida, on its behalf. They are personally known to me and they did not take an oath.

Signature of Notary

Print, Type, or Stamp Commissioned Name of Notary



6557 Hazeltine National Drive
Suite One
Orlando, FL 32822
407.856.2400

May 21, 2019

Hillsborough County Aviation Authority
Attn: Brian Rumble
Program Manager
Tampa International Airport

Subject: Request for Change Order CE#0001 – Owner Directive – Maintenance &
Police Space in Long-Term Parking Garage
8230 18 – MTCE Project
Tampa International Airport

Dear Brian:

Hensel Phelps Construction Co. is hereby submitting Change Estimate #0001. Included are costs to design and preconstruction of the Police & Maintenance Space within the Long-Term Parking Garage 1st floor.

Within this submission is a narrative and breakout of costs for a credit being provided by HNTB for the base scope that was included within the Part 1 Agreement.

The total cost for this RCO is \$1,488,145.47 including all documentation to substantiate the additional cost requested. These costs do not include any Construction Administration costs as they will be incorporated into the Part 2 Agreement at a later date.

Please do not hesitate to contact the project team with any questions or concerns.

Sincerely,
HENSEL PHELPS CONSTRUCTION CO.

Drew Krizman

Drew Krizman
Project Manager

c: 8016169, DK, SG

Tampa International Airport
Scope of work for
HCAA Office building in the Long-Term Parking Garage

This is a design build project requested by HCAA. The project consists of the following:

Approximately 33,460 SF of office building and other spaces to be located on the ground level of the Tampa Airport Long Term Parking Garage (LTPG). See the attached proposed plan. HCAA intends to place the following entities in the space:

1. HCAA Maintenance and shops
2. HCAA Airport Police/Traffic department
3. Bombardier offices and CPU room (APM maintenance company)
4. Flagship breakroom, storage and lockers (HCAA's janitorial contractor)
5. Frontier (telecommunication company central switching room)

The Frontier space will be a stand-alone space. The HCAA Maintenance, HCAA Police/Traffic, Flagship and Bombardier areas are planned to be in the same building.

The intent is to construct a new building at ground level under the second-floor deck of the LTPG. The walls would be a 2-hour rated concrete block walls on east, west and south sides with vision windows facing to the north. Louvers would be installed on the second level of the parking deck to prevent wind driven rain from entering on 2nd floor parking deck, reducing the amount of water that could pool above the office building on ground level. The second-floor deck would be treated to waterproof the space below.

Since most of the north side of the LTPG will be enclosed, mechanical ventilation on the entire ground floor of the LTPG is assumed. There are some existing shafts as this was mechanically ventilated previously. This will have to be modelled to prove code can be met to provide adequate ventilation and other code intent.

Persons egressing from the upper floors of the LTPG will descend to the ground floor inside the LTPG. These egress points must be extended to the perimeter of the LTPG. Exits from the new office spaces will be to the east, north and west and not south into the LTPG.

New vehicle striping and fencing will separate office parking vehicle access at ground level from the rest of the existing revenue parking in the southern part of the LTPG. Also, additional new exterior parking and unloading/loading areas for the office building will be created to the east and west ends of the LTPG. See attached plan.

HCAA intends to park HCAA employees above the ground floor office space on the second level parking deck and have access to two new elevators to access the ground level below and main terminal transfer level above.

Elevators description

The intent is to create two separate elevator shafts on either side of the new Blue side center pedestrian bridge. The elevators would be “custom elevators” to fit within the narrow shaft space available. Persons coming from the main terminal will cross the center pedestrian bridge and enter into the LTPG and then enter a separate lobby for each elevator. One elevator would be signed as the “public access” elevator and the other as an “employee /service” elevator. There would be a stop at the second parking deck level to access employee parking. Since the second level deck is recessed below the transfer level a pedestrian bridge from the elevator shaft will be necessary to access the second parking level. At ground level a lobby will be created for each elevator which will have direct and air-conditioned access to the office building. The elevator shafts will be 2-hour rated. Fresh air intake shafts for air handling room would most likely be attached to each of the elevator shafts as fresh air is needed from above the ground floor. (It is assumed that intake air from just above transfer level can be used).

Most of this building will contain one story. But note, there is a two-story space at the section of the building in the center that projects towards the north. This space is a two-story volume incorporating the access bridges to the second parking level. This will require a two-story curtain wall and a two-story structural frame under the parking deck.

LTPG Fan rooms

Four large fan rooms will need to be created for this project to ventilate the LTPG. In fact, there were fan rooms before in the LTPG when this was a rental car storage facility and they were recently demolished. These rooms would be concrete block rooms with large louver walls. Existing shafts left over from the previous fan rooms would be reused. Disciplines involving structural, architecture, mechanical and electrical would have to include this in their scope of work.

Frontier space requirements (Frontier is the telecommunications company which provides telephone and data access to the airport.)

- Fire Protection – Standard fire sprinklers in order to get shell approved by City of Tampa. Frontier would then have to demolish and install non-wet fire suppression system later itself.
- Fire alarm stubbed into the space.
- Overhead door and single door access with a rough in for card access at door (empty pipes) from door devices to above ceiling.
- 1'-0" Raised Floor elevation.
- Access Ramp.
- Regular HVAC System – air stubbed into space. Any redundant or special HVAC for Frontier equipment by Frontier as a tenant improvement.
- Electrical conduit stub-up to the building.
- Weatherproofing.
- Sealed concrete flooring, CMU Walls to structure.
- No Ceiling, existing pipes overhead will need to be re-routed by HP team.
- No emergency generator for Frontier, no backup power (other than for life/safety systems), no specialty telecom systems or infrastructure.
- Frontier needs conduits heading west to get to all its infrastructure. Provide five, 4" sleeves from its room to a location in the parking lot as shown.

Maintenance and Police/Traffic space requirements - see attached spreadsheet and comments regarding each space

Description of each discipline:

Investigation of existing conditions

Subsurface Utility Engineering

- Underground investigations of the east and west parking, and vehicle access areas.
- Under slab investigations inside the LTPG. (Previous conduit was discovered in ground level slab).
- Sample cores and x-ray/radar of LTPG ground slab and potentially of upper decks.
- 3-D civil data of all underground utilities and easements.
- SUE to locate borings.

Survey

- Survey of site and static LIDAR scan inside LTPG within proposed project building area.
- Survey all drainage structures.
- Survey to locate borings.

Geotech

- Borings for parking lot pavements --- 3 borings for future east lot, 3 on future west lot.
- Site retaining walls and for CMU foundations – 3 borings for south edge of proposed west parking lot where retaining wall will be required.
- Four borings inside long term garage where future foundation for concrete block south and north walls will be located.

Design

Civil

- All site design including access roads, parking lots, grading, drainage, retaining walls, striping, MOT, site lighting layout (circuiting design by Electrical sub).

Landscaping

- Small amount of landscaping and irrigation on east and west perimeter of site that is disturbed by this project.

Structural:

- Structural demolition drawings including existing slab, soffits, precast spandrels, etc.
- Exterior and special interior wall structures. Special interior walls include jail cells (to comply with all applicable codes), armory, special hanging loads on maintenance walls.
- Pedestrian bridges from elevator shafts to second level parking deck. Approximately 10 feet wide and 20 feet long.
- Wall and other required foundations.

- Lightweight structure to hang a waterproofing lightweight membrane assembly under second floor deck in Frontier space.
- Hanging requirements from parking structure deck above.
- Two separate elevator shafts up to Transfer level. Elevator stops at main terminal transfer level, second parking deck level and ground level.
- Pedestrian bridge from elevator shaft to 2nd level parking deck from each of two elevator shafts.

Architecture

- Demolition.
- Architectural design.
- Interior design.
- Two separate elevator shafts, design with custom elevators.
- Architectural breakdown of all spaces.
- Louver design at upper parking floor.
- Waterproofing design for parking deck
- Renderings during design to communicate exterior and selected key interior spaces.
- Specs.
- All interior LTPG parking layout docs.
- Special waterproofing membrane assembly under second floor deck at Frontier space.

FF&E design – NO FF&E fee and scope is provided.

- *No Furniture and equipment layouts*
- *No FF&E schedules*
- *Millwork and workstations are considered FF&E*

Fire life safety code analysis

- Egress plan of office building.
- Egress plan of existing LTPG.
- Fire separation between office and LTPG.
- Ventilation variance for City of Tampa (working with mechanical engineer).
- Other code issues required of combined office and garage structures.

Acoustics

- Acoustic consulting for separate of acoustic privacy from various functions.

Architectural lighting

- Architectural lighting consultation for key spaces and general office lighting.

Waterproofing consultant

- Provide waterproofing scheme, materials and specification to waterproof upper parking deck or under deck.

Mechanical

- Office mechanical, HVAC, plumbing, fire protection.
- LTPG Ventilation.
- Fire protection office bldg.
- Modifications to fire protection in LTPG.

Electrical

- Demo.
- Power, lighting & fire alarm for Office.
- Reconfiguration of lighting and other electrical in LTPG.
- Power for LTPG ventilation.
- Power for elevators.
- Emergency power.
- All other electrical required.

IT/low voltage

- Conduit routing assistance for Frontier.
- IT systems all spaces.
- Access control to all suites.

Signage

- Public wayfinding (public needs access to the areas from terminal).
- Internal office interior signage for each office /walled space.
- Reconfiguration of LTPG signage to adjust vehicle circulation.
- Parking lots signage.

Clarifications for HCAA Office building in the Long-Term Parking Garage

1. The submitted fee has limited meetings for programming/concept layout plans for the spaces in the project. It is assumed that after the allocated meetings and plan revisions below, the plan will be set, and construction documentation will begin.
 - a. For Maintenance we have allocated 2 programming meetings with 2 plan revisions to get to an approved layout plan.
 - b. For Police/Traffic we have allocated 2 programming meetings with 2 plan revisions to get to an approved layout plan.
 - c. For Frontier we have allocated 2 meetings and one plan revision.
 - d. For Bombardier we have allowed 2 meetings and one plan revision
 - e. For Flagship we have allowed 2 meetings with one plan revision
 - f. For exterior access drives, exterior parking and LTPG parking layouts in the garage we have allocated 2 meetings and 2 plan revisions to get to an approved parking and vehicular layout.

2. Waterproofing

The design fees assume that new louver system will be installed on the second parking level façade to keep out rain on the second level and that the waterproofing for the occupied space below will be by applying traffic coating to the second parking deck. No design fees are included for a sub roof under the second level parking deck.

3. Code implications

The design fees assume the project will be allowed by the City of Tampa to mechanically ventilate the ground floor of the LTPG. This assumes same number of fan rooms, which existed before, will be acceptable.

It also assumes that persons exiting down the stairs of the LTPG to the ground level can be redirected to the perimeter of the building without building 2-hour corridors from each stair to the perimeter of the garage.

It assumes a rated wall along the south face of the new maintenance/police office building. Any other requirements for code implications are unknown and are not included in this fee.

4. FF&E

FF&E furniture layout and schedules are not included in this fee. This is for architectural building design only as stated construction cost does not cover FF&E. For storage and workstations for maintenance and Police/Traffic it is assumed storage racks and workstations are part of FF&E. Custom designed millwork is not included for storage systems and workstations.

5. Frontier

The design fee assumes Frontier will have no interior design work, only a tenant shell for Frontier to have for Frontier to fit out.

6. Bombardier

The design fee assumes replacing Bombardier spaces in kind, but no FF&E design and no millwork. Bombardier will move, provide and install their own Computer, IT and train control systems.

7. Flagship

The design fee assumes replacing Flagship spaces in kind, but no FF&E design and no millwork. Flagship will move, provide and install their own computer, IT systems.

Credit for maintenance office design services in the for the new Central Utility Plant

The Central Utility Plant (CUP) design consists of an area of 39,840 square feet. In the original CUP master plan conducted by TLC Engineering Solutions; TLC had allocated 3905 square feet of maintenance office area in the CUP building. For the new office building in the Long-Term Parking Garage (LTPG), design fees for the Maintenance office of 3905 SF area *have been discounted* for that amount of design work for the new office complex in the LTPG.

In addition, the HNTB design team has spent considerable time and labor studying maintenance office options per HCAA requests. That consisted of:

1. **The West Quad Deck structural and architectural and parking feasibility study.**
2. **Central terminal maintenance Site studies** -HNTB studied a series of options for much larger maintenance office locations around the central terminal area, including:
 - a. Multiple sites at FAA Lot,
 - b. Various layouts to add a much large maintenance office on upper stories of the CUP
 - c. New standalone maintenance building site at future FAA tower site
 - d. Several options to locate only the maintenance department to the LTPG
3. **Conducted programming additional interviews** with Maintenance and police and traffic departments
4. **Studied new layout in LTPG** to co-locate maintenance, Frontier, Bombardier and Flagship into one office building in the LTPG. HCAA indicated this was the final option and the HNTB design team started design fee pricing for this option
5. **Studied another new layout to add Police/Traffic in LTPG** and attended additional programming meeting with police and traffic to finalize the layout including parking layouts on ground and 2nd level of the LTPG. This is the current preferred option.

The design work for the maintenance office area as part of the CUP, were a minor part of original CUP design. The most challenging design, and the most time /effort consuming engineering and architectural work is for the central plant itself. The following disciplines have discounted their maintenance office design fees for the new maintenance space with the flowing explanation and amounts:

1. Architectural

This consists of management of the office design for all disciplines. The credit includes not designing interior office walls, ceilings, flooring, some millwork, some doors, and a locker rooms. No FF&E design was in the original scope. The is further adjusted due the multiple studies to arrive at the preferred maintenance and Police office location and layout.

2. Structural

Since the office space is an internal function there was very little structural fee related to the office function. But some structural work is discounted and specialty detailing of hanging shelving is discounted. This is further adjusted due to the structural feasibility of the West Quad deck study.

3. Mechanical (HVAC, Fire protection, IT design)

The over whelming mechanical/IT design costs for the CUP is for the plant itself. Only a small amount branch ductwork and diffusers, limited fire sprinkler layout were required for the offices as part of a bigger building. All air handling engineering design, fire pump design, chilled and hot water system, potable water systems, energy modelling, HVAC calculations, fire protection

hydraulic calculations, chilled and hot water system calculations, and many other overall building and drawings requirements are not impacted by omission of the maintenance offices.

4. Electrical (Power, lighting, fire alarm)

The over whelming electrical design costs for the CUP is for the plant itself. Only a small amount lighting, power and fire alarm design is involved in the maintenance office part. The CUP design requires large amount of time required to coordinate with TECO for the CUP power and TECO line reroute at the CUP site. In addition, most of the design time is for the power and lighting for the plant itself as it consumes 95% of all power for the building omitting the maintenance offices. All power, lighting and voltage drop calculations and energy modelling is driven by the main CUP plant and the office had not appreciable impact.

The cost discount per discipline is as follows:

	Design fee Discount
Architectural	\$79,560.34
Structural	\$29,560.52
Mechanical/IT	\$10,889.84
<u>Electrical</u>	<u>\$ 4,600.00</u>
Total Discount	\$124,610.70

The design fees for the New Maintenance space for the LTPG office have deducted these discounts.

Main Terminal Curbside Expansion, New Energy Plant and Related Work

HCAA Project Numbers 8230-18-BCS, 8230-18-RCS, 8200-18, 8205-18-CEP, 8205-18-LDB, 8900-18, 8240-19

3/29/2019

Basic Design Services		30%	60%	90%	100%	Total	Construction	Total	W/MBE %	% W/MBE	% Construction
Engineering & Preconstruction Services		Design Dev.	Design Dev.	Const. Docs	Final Docs	Part 1	Administration		of Fee	Goal	Cost
PCO-0001	Main Terminal Curbside Expansion - Hensel Phelps	\$ 49,737.92	\$ 43,664.98	\$ 47,367.58	\$ 29,153.10	\$ 169,923.57					
PCO-0001	Main Terminal Curbside Expansion - Beck	\$ 82,801.08	\$ 50,988.12	\$ 34,711.08	\$ 34,711.08	\$ 203,211.36					
PCO-0001	Main Terminal Curbside Expansion - HNTB Arch	\$ 171,484.88	\$ 146,768.93	\$ 206,954.21	\$ 54,893.79	\$ 580,101.81	\$ 126,330.47	\$ 706,432.28			
PCO-0001	Main Terminal Curbside Expansion - HNTB Arch Credit					\$ (79,560.34)		\$ (79,560.34)			
PCO-0001	Main Terminal Curbside Expansion - HNTB Struct	\$ 7,999.93	\$ 13,590.64	\$ 16,880.25	\$ 10,074.90	\$ 48,545.72	\$ 2,617.34	\$ 51,163.06			
PCO-0001	Main Terminal Curbside Expansion - HNTB Struct Credit					\$ (29,560.52)		\$ (29,560.52)			
PCO-0001	Main Terminal Curbside Expansion - HNTB Civil	\$ 39,441.42	\$ 40,468.96	\$ 39,498.66	\$ 14,472.39	\$ 133,881.43	\$ 8,575.31	\$ 142,456.74			
PCO-0001	Main Terminal Curbside Expansion - Arehna	\$ 9,658.22	\$ -	\$ -	\$ -	\$ 9,658.22	\$ -	\$ 9,658.22			
PCO-0001	Main Terminal Curbside Expansion - ECHO	\$ 49,536.25	\$ 7,264.95	\$ -	\$ -	\$ 56,801.20	\$ -	\$ 56,801.20			
PCO-0001	Main Terminal Curbside Expansion - MCE	\$ 15,414.46	\$ 17,873.13	\$ 20,485.50	\$ 17,022.55	\$ 70,795.64	\$ 20,062.39	\$ 90,858.02			
PCO-0001	Main Terminal Curbside Expansion - Ayres	\$ 20,540.27	\$ 8,471.70	\$ 8,471.70	\$ 8,471.70	\$ 45,955.37	\$ -	\$ 45,955.37			
PCO-0001	Main Terminal Curbside Expansion - Henderson (Acoustics)	\$ -	\$ -	\$ -	\$ -	\$ -	\$ -	\$ -			
PCO-0001	Main Terminal Curbside Expansion - Henderson (Arch Lighting)	\$ -	\$ -	\$ -	\$ -	\$ -	\$ -	\$ -			
PCO-0001	Main Terminal Curbside Expansion - Henderson (Code Consulting)	\$ 20,331.91	\$ 7,915.32	\$ 1,073.63	\$ 1,073.63	\$ 30,394.48	\$ -	\$ 30,394.48			
PCO-0001	Main Terminal Curbside Expansion - TLC	\$ 9,385.72	\$ 2,226.47	\$ 3,906.03	\$ 5,170.68	\$ 20,688.91	\$ 2,213.05	\$ 22,901.96			
PCO-0001	Main Terminal Curbside Expansion - TLC Credit					\$ (10,889.84)		\$ (10,889.84)			
PCO-0001	Main Terminal Curbside Expansion - LA Design	\$ -	\$ 6,871.25	\$ 6,068.12	\$ 5,102.29	\$ 18,041.66	\$ 9,051.99	\$ 27,093.65			
PCO-0001	Main Terminal Curbside Expansion - Voltair	\$ 53,815.29	\$ 49,973.17	\$ 43,898.63	\$ 28,206.61	\$ 175,893.70	\$ 58,862.45	\$ 234,756.16			
PCO-0001	Main Terminal Curbside Expansion - Voltair Credit					\$ (4,600.00)		\$ (4,600.00)			
PCO-0001		\$ -	\$ -	\$ -	\$ -	\$ -	\$ -	\$ -			
Design Phase Sub Total		\$ 530,147.35	\$ 396,077.60	\$ 429,315.39	\$ 208,352.72	\$ 1,439,282.36	\$ 227,713.01	\$ 1,298,460.44			
Reimbursable Expenses											
PCO-0001	Main Terminal Curbside Expansion - Hensel Phelps	\$ 17,386.15	\$ 4,475.07	\$ 2,936.64	\$ 2,263.24	\$ 27,061.11	\$ -	\$ 27,061.11			
PCO-0001	Main Terminal Curbside Expansion - Beck	\$ -	\$ -	\$ -	\$ -	\$ -	\$ -	\$ -			
PCO-0001	Main Terminal Curbside Expansion - HNTB Arch	\$ 4,200.00	\$ 4,200.00	\$ 5,650.00	\$ 1,850.00	\$ 15,900.00	\$ 8,600.00	\$ 24,500.00			
PCO-0001	Main Terminal Curbside Expansion - HNTB Struct	\$ -	\$ -	\$ -	\$ -	\$ -	\$ -	\$ -			
PCO-0001	Main Terminal Curbside Expansion - HNTB Civil	\$ 1,738.23	\$ 1,784.77	\$ 1,742.40	\$ 636.59	\$ 5,902.00	\$ 1,220.00	\$ 7,122.00			
PCO-0001	Main Terminal Curbside Expansion - Arehna	\$ -	\$ -	\$ -	\$ -	\$ -	\$ -	\$ -			
PCO-0001	Main Terminal Curbside Expansion - ECHO	\$ -	\$ -	\$ -	\$ -	\$ -	\$ -	\$ -			
PCO-0001	Main Terminal Curbside Expansion - MCE	\$ -	\$ -	\$ -	\$ -	\$ -	\$ -	\$ -			
PCO-0001	Main Terminal Curbside Expansion - Ayres	\$ -	\$ -	\$ -	\$ -	\$ -	\$ -	\$ -			
PCO-0001	Main Terminal Curbside Expansion - Henderson (Acoustics)	\$ -	\$ -	\$ -	\$ -	\$ -	\$ -	\$ -			
PCO-0001	Main Terminal Curbside Expansion - Henderson (Arch Lighting)	\$ -	\$ -	\$ -	\$ -	\$ -	\$ -	\$ -			
PCO-0001	Main Terminal Curbside Expansion - Henderson (Code Consulting)	\$ -	\$ -	\$ -	\$ -	\$ -	\$ -	\$ -			
PCO-0001	Main Terminal Curbside Expansion - TLC	\$ -	\$ -	\$ -	\$ -	\$ -	\$ -	\$ -			
PCO-0001	Main Terminal Curbside Expansion - LA Design	\$ -	\$ -	\$ -	\$ -	\$ -	\$ -	\$ -			
PCO-0001	Main Terminal Curbside Expansion - Voltair	\$ -	\$ -	\$ -	\$ -	\$ -	\$ -	\$ -			
PCO-0001	0	\$ -	\$ -	\$ -	\$ -	\$ -	\$ -	\$ -			
Reimbursables Sub Total		\$ 23,324.39	\$ 10,459.84	\$ 10,329.04	\$ 4,749.84	\$ 48,863.11	\$ 9,820.00	\$ 58,683.11			
Total Fee, Allowances, Reimbursable Expenses		\$ 553,471.74	\$ 406,537.45	\$ 439,644.43	\$ 213,102.55	\$ 1,488,145.47	\$ 237,533.02	\$ 1,357,143.55			

30% Design Fee

Project Fee Proposal - Hensel Phelps Team															
Main Terminal Curbside Expansion - HNTB Struct															
HCAA Project Number 8230-18															
3/29/2019															
Scope/Task			Sr. Struct	Proj Struct	Struct E.	Sr. Tech	Tech.	Admin							Total
Basic Design Services			Hours	Hours	Hours	Hours	Hours	Hours	Hours	Hours	Hours	Hours	Hours	Hours	
Task - 30% Design															
1	MCE Management and Coordination		22.00												22.00
2	Review			18.30											18.30
3															0.00
4															0.00
5															0.00
6															0.00
7															0.00
8															0.00
9															0.00
10															0.00
11															0.00
	Subtotal Hours		22.00	18.30	0.00	0.00	0.00	0.00	0.00	0.00	0.00	0.00	0.00	0.00	40.30
	Rate		\$ 81.25	\$ 56.25	\$ 37.00	\$ 39.00	\$ 28.00	\$ 20.00							
	Subtotal Direct Labor		\$ 1,787.50	\$ 1,029.38	\$ -	\$ -	\$ -	\$ -	\$ -	\$ -	\$ -	\$ -	\$ -	\$ -	\$ 2,816.88
	Subtotal Burdened Labor @			2.84											\$ 7,999.93

Project Fee Proposal - Hensel Phelps Team															
Main Terminal Curbside Expansion - HNTB Civil															
HCAA Project Number 8230-18															
3/29/2019															
Scope/Task			PM	PD	Chief Eng/Plant	Sr. PE	PE	Eng.	Sr. Des.	Des.	Sr. Tech	Clerical	PA	Specialist	Total
Basic Design Services			Hours	Hours	Hours	Hours	Hours	Hours	Hours	Hours	Hours	Hours	Hours	Hours	
Task - 30% Design															
1	Project Management		12.75	0.00	0.00	0.00	0.00	0.00	0.00	0.00	0.00	3.75	3.75	0.00	20.3
2	Grading/Roadway Design		2.25	0.00	3.75	9.00	9.00	13.50	7.50	9.00	4.50	1.50	0.00	0.00	60.0
3	Drainage Design		1.50	0.00	3.75	6.00	9.00	10.50	5.25	6.75	3.75	1.50	0.00	0.00	48.0
4	Signing and Pavement Marking		1.50	0.00	3.75	6.00	9.75	10.50	5.25	6.75	3.75	1.50	0.00	0.00	48.8
5	Site Lighting Design		0.75	0.00	3.00	6.00	9.00	7.50	3.75	6.00	4.50	0.75	0.00	0.00	41.3
6	Environmental Permits		1.50	0.00	0.00	0.00	3.00	2.25	0.00	0.00	0.00	0.00	0.00	0.00	6.8
7	Wall Structural Engineering		0.75	0.00	1.50	3.75	2.25	0.00	2.25	2.25	1.50	0.00	0.00	0.00	14.3
8			0.00	0.00	0.00	0.00	0.00	0.00	0.00	0.00	0.00	0.00	0.00	0.00	-
9			0.00	0.00	0.00	0.00	0.00	0.00	0.00	0.00	0.00	0.00	0.00	0.00	-
10			0.00	0.00	0.00	0.00	0.00	0.00	0.00	0.00	0.00	0.00	0.00	0.00	-
11			0.00	0.00	0.00	0.00	0.00	0.00	0.00	0.00	0.00	0.00	0.00	0.00	-
	Subtotal Hours		21.00	0.00	15.75	30.75	42.00	44.25	24.00	30.75	18.00	9.00	3.75	0.00	239.25
	Rate		\$ 123.85	\$ 139.08	\$ 91.82	\$ 70.16	\$ 53.40	\$ 44.27	\$ 53.72	\$ 43.26	\$ 27.71	\$ 24.80	\$ 37.37	\$ 97.23	
	Subtotal Direct Labor		\$ 2,600.85	\$ -	\$ 1,446.17	\$ 2,157.42	\$ 2,242.80	\$ 1,958.95	\$ 1,289.28	\$ 1,330.25	\$ 498.78	\$ 223.20	\$ 140.14	\$ -	\$ 13,887.83
	Subtotal Burdened Labor @			2.84											\$ 39,441.42

Project Fee Proposal - Hensel Phelps Team															
Main Terminal Curbside Expansion - Arehna															
HCAA Project Number 8230-18															
3/29/2019															
Scope/Task			Project Manager	Principal Engineer	Senior Engineer	Technical Engineer	Engineer Intern	Senior Design Engineer	Engineering Technician	Secretary/Clerk	Engineering Technician				Total
Basic Design Services			Hours	Hours	Hours	Hours	Hours	Hours	Hours	Hours	Hours	Hours	Hours	Hours	
Task - 30% Design															
1	Geotechnical		9.60	1.60	16.00	14.40	16.00	14.40	4.80	0.80	8.00				85.60
2															0.00
3															0.00
4															0.00
5															0.00
6															0.00
7															0.00

30% Design Fee

6	- light fixture cut sheets (assume 5 types)																0.00														
7	- lighting calculations (2 spaces)																0.00														
8	- internal meetings																0.00														
9	- meetings with hntb (assume 3 meetings)																0.00														
10	General Office (shop, wk rms, support, rr)																0.00														
11	- light fixture cut sheets (assume 5 types)																0.00														
Subtotal Hours			0.00	0.00	0.00	0.00	0.00	0.00	0.00	0.00	0.00	0.00	0.00	0.00	0.00	0.00	0.00														
Rate		\$	175.00	\$	145.00	\$	150.00	\$	130.00	\$	120.00	\$	20.00	\$	-	\$	-	\$	-	\$	-	\$	-	\$	-	\$	-	\$	-		
Subtotal Direct Labor		\$	-	\$	-	\$	-	\$	-	\$	-	\$	-	\$	-	\$	-	\$	-	\$	-	\$	-	\$	-	\$	-	\$	-		
Subtotal Burdened Labor @					2.90																									\$	-

Project Fee Proposal - Hensel Phelps Team																															
Main Terminal Curbside Expansion - Henderson (Code Consulting)																															
HCAA Project Number 8240-19																															
3/29/2019																															
Scope/Task			Principal	Director	Sr. Code Cons	Code Cons	BIM/CAD	Admin									Total														
Basic Design Services			Hours	Hours	Hours	Hours	Hours	Hours	Hours	Hours	Hours	Hours	Hours	Hours	Hours	Hours															
Task - 30% Design																															
1	Code compliance assessment		0.00	3.08	18.48	12.32	0.00	0.00									33.88														
2	code narrative		0.00	1.54	9.24	6.16	0.00	0.00									16.94														
3	egress/life safety drawings - offices		0.00	1.54	3.08	0.00	12.32	0.00									16.94														
4	egress/life safety drawings - parking garage		0.00	1.54	6.16	0.00	30.80	0.00									38.50														
5	site visit/survey		0.00	0.00	4.62	0.00	0.00	0.00									4.62														
6	meeting with AHJ		0.00	0.00	4.62	0.00	0.00	0.00									4.62														
7	meetings (design team)		0.00	0.00	9.24	0.00	0.00	0.00									9.24														
8	general code consulting		0.00	0.00	12.32	0.00	0.00	0.00									12.32														
9	variance for mechanical ventilation		0.00	1.54	12.32	6.16	0.00	0.00									20.02														
10			0.00	0.00	0.00	0.00	0.00	0.00									0.00														
11			0.00	0.00	0.00	0.00	0.00	0.00									0.00														
Subtotal Hours			0.00	9.24	80.08	24.64	43.12	0.00	0.00	0.00	0.00	0.00	0.00	0.00	0.00	0.00	157.08														
Rate		\$	72.16	\$	60.90	\$	60.10	\$	34.00	\$	18.50	\$	20.00	\$	-	\$	-	\$	-	\$	-	\$	-	\$	-	\$	-	\$	-		
Subtotal Direct Labor		\$	-	\$	562.72	\$	4,812.81	\$	837.76	\$	797.72	\$	-	\$	-	\$	-	\$	-	\$	-	\$	-	\$	-	\$	-	\$	-	\$	7,011.00
Subtotal Burdened Labor @					2.90																								\$	20,331.91	

Project Fee Proposal - Hensel Phelps Team																														
Main Terminal Curbside Expansion - TLC																														
HCAA Project Number 8240-19																														
3/29/2019																														
Scope/Task			Principal		Sr. Engineer	Engineer II	Engineer I	Admin	Sr. Tech	Tech II	CAD Tech						Total													
Basic Design Services			Hours	Hours	Hours	Hours	Hours	Hours	Hours	Hours	Hours	Hours	Hours	Hours	Hours	Hours														
Task - 30% Design																														
1	Evaluation/relocation existing infra.		0.00	0.00	0.00	0.00	0.00	0.00	1.80	0.90	0.00						2.70													
2	Site Walk and Field Verification		0.00	0.00	0.00	0.00	0.00	0.00	0.00	0.90	0.00						0.90													
3	Design Meetings		0.00	0.00	0.00	0.00	0.00	0.00	0.90	0.90	0.00						1.80													
4	Calculations		10.00	0.00	0.00	1.80	2.00	0.00	0.00	0.00	0.00						13.80													
5	Drawing Development		0.00	0.00	0.00	0.00	2.00	0.00	1.80	1.90	1.80						7.50													
6	Specification Development		9.50	0.00	0.00	0.00	0.00	2.00	0.90	0.00	0.00						12.40													
7	Coordination		0.00	0.00	0.00	1.80	0.00	0.00	0.00	0.90	0.00						2.70													
8	Quality Control		6.50	0.00	0.00	0.00	0.00	0.00	0.90	0.00	0.00						7.40													
9	Response to Comments		0.00	0.00	0.00	1.80	0.00	0.00	0.00	0.90	0.00						2.70													
10	Project Management		0.90	0.00	0.00	0.00	0.00	0.00	0.90	0.00	0.00						1.80													
11			0.00	0.00	0.00	0.00	0.00	0.00	0.00	0.00	0.00						0.00													
Subtotal Hours			26.90	0.00	0.00	5.40	4.00	2.00	7.20	6.40	1.80	0.00	0.00	0.00	0.00	0.00	53.70													
Rate		\$	77.88	\$	-	\$	52.88	\$	42.09	\$	36.63	\$	25.72	\$	62.50	\$	32.69	\$	25.50	\$	-	\$	-	\$	-	\$	-	\$	-	
Subtotal Direct Labor		\$	2,094.97	\$	-	\$	-	\$	227.29	\$	146.52	\$	51.44	\$	450.00	\$	209.22	\$	45.90	\$	-	\$	-	\$	-	\$	-	\$	3,225.33	
Subtotal Burdened Labor @					2.91																								\$	9,385.72

Project Fee Proposal - Hensel Phelps Team																
Main Terminal Curbside Expansion - LA Design																
HCAA Project Number 8240-19																

30% Design Fee

3/29/2019																
Scope/Task		Sr Designer	Ldsp Arc	Sr Ldsp Arc	Ch Scientist	Hours	Hours	Hours	Hours	Hours	Hours	Hours	Hours	-	Total	
Basic Design Services		Hours	Hours	Hours	Hours	Hours	Hours	Hours	Hours	Hours	Hours	Hours	Hours	Hours	-	
Task - 30% Design																
1																0.00
2																0.00
3																0.00
4																0.00
5																0.00
6																0.00
7																0.00
8																0.00
9																0.00
10																0.00
11																0.00
Subtotal Hours		0.00	0.00	0.00	0.00	0.00	0.00	0.00	0.00	0.00	0.00	0.00	0.00	0.00	0.00	0.00
Rate		\$ 32.78	\$ 46.00	\$ 55.00	\$ 55.00	\$ 20.00	\$ 20.00	\$ 20.00	\$ 20.00	\$ -	\$ -	\$ -	\$ -	\$ -	\$ -	\$ -
Subtotal Direct Labor		\$ -	\$ -	\$ -	\$ -	\$ -	\$ -	\$ -	\$ -	\$ -	\$ -	\$ -	\$ -	\$ -	\$ -	\$ -
Subtotal Burdened Labor @			2.42													\$ -

Project Fee Proposal - Hensel Phelps Team															
Main Terminal Curbside Expansion - Voltair															
HCAA Project Number 8240-19															
3/29/2019															
Scope/Task	Principal	Electrical Director	Senior Electrical Engineer	Electrical Engineer II	Sr. Electrical Designer	Electrical Designer	Mechanical EOR	Mechanical Engineer II	Mechanical Engineer I	Sr Fire Protection Designer	Senior Plumbing Designer	BIM Coordinator	Clerical	Total	
Basic Design Services	Hours	Hours	Hours	Hours	Hours	Hours	Hours	Hours	Hours	Hours	Hours	Hours	Hours	-	
Task - 30% Design															
1	Weekly Design Meetings	0.00	3.65	3.65	3.65	0.00	0.00	3.65	3.65		3.65			21.90	
2	Project Setup / Weekly Updates (BIM)	0.00	0.00	0.00	0.00	0.00	0.00	0.00	0.00	0.00	0.00	34.31		34.31	
3	Site Investigations	0.00	0.00	2.19	8.03			1.46		5.11	2.19	2.19		21.17	
4	Electrical Power Design	0.00	3.65	13.14	4.38	18.25	18.25							57.67	
5	Fire Protection Design	0.00						2.19			14.60			16.79	
6	Fire Alarm Design	0.00	2.19		10.95									13.14	
7	Lighting Design	0.00	8.03	13.14	16.79									37.96	
8	HVAC Design	0.00						16.06	54.75	73.00				143.81	
9	Plumbing Design	0.00						2.19		73.00	43.07			118.26	
10	QAQC, Internal	2.19		7.30				2.19			2.19	2.19	2.92	18.98	
11	QAQC, External w/ All Trades			7.30					5.11		2.19	2.19		16.79	
12	HCAA Design Team Meetings/Presentations		2.19					2.19						4.38	
13	HCAA Review Meetings		2.19					2.19						4.38	
14	Specifications		2.19	7.30				1.46	2.19		1.46	2.19	8.03	24.82	
15		0.00	0.00	0.00	0.00	0.00	0.00	0.00	0.00	0.00	0.00	0.00	0.00	0.00	
16		0.00	0.00	0.00	0.00	0.00	0.00	0.00	0.00	0.00	0.00	0.00	0.00	0.00	
Subtotal Hours		2.19	24.09	54.02	43.80	18.25	18.25	33.58	65.70	151.11	22.63	55.48	37.23	8.03	534.36
Rate		\$ 85.72	\$ 69.33	\$ 58.19	\$ 40.56	\$ 43.99	\$ 40.55	\$ 53.50	\$ 40.81	\$ 32.83	\$ 48.20	\$ 48.20	\$ 43.99	\$ 29.38	
Subtotal Direct Labor		\$ 187.73	\$ 1,670.16	\$ 3,143.42	\$ 1,776.53	\$ 802.82	\$ 740.04	\$ 1,796.53	\$ 2,681.22	\$ 4,960.94	\$ 1,090.77	\$ 2,674.14	\$ 1,637.75	\$ 235.92	\$ 23,397.95
Subtotal Burdened Labor @			2.30												\$ 53,815.29

60% Design Fee

Project Fee Proposal - Hensel Phelps Team														
Main Terminal Curbside Expansion - Arehna														
HCAA Project Number 8230-18														
3/29/2019														
Scope/Task	Project Manager	Principal Engineer	Senior Engineer	Technical Engineer	Engineer Intern	Senior Designer	Engineering Technician	Secretary/Clerk	Engineering Technician	-	-	-	-	Total
Basic Design Services	Hours	Hours	Hours	Hours	Hours	Hours	Hours	Hours	Hours	Hours	Hours	Hours	Hours	-
Task - 60% Design														
1	code assessments & report revisions													0.00
2	egress drawings - Blue side													0.00
3	fire modeling & timed egress analysis													0.00
4	Code compliance issues (AMMRs)													0.00
5	meetings with City of Tampa													0.00
6	general code consulting													0.00
7														0.00
8														0.00
9														0.00
10														0.00
11														0.00
Subtotal Hours		0.00	0.00	0.00	0.00	0.00	0.00	0.00	0.00	0.00	0.00	0.00	0.00	0.00
Rate		\$ 60.10	\$ 64.90	\$ 56.97	\$ 36.06	\$ 25.96	\$ 29.81	\$ 25.00	\$ 19.00	\$ 16.00	\$ -	\$ -	\$ -	\$ -
Subtotal Direct Labor		\$ -	\$ -	\$ -	\$ -	\$ -	\$ -	\$ -	\$ -	\$ -	\$ -	\$ -	\$ -	\$ -
Subtotal Burdened Labor @			3.00											\$ -

Project Fee Proposal - Hensel Phelps Team														
Main Terminal Curbside Expansion - ECHO														
HCAA Project Number 8230-18														
3/29/2019														
Scope/Task	Project Manager	Professional Surveyor	Surveyor / CADD Tech	Admin Assistant	SUE Designating Crew	SUE Locating Crew	Survey Crew	-	-	-	-	-	-	Total
Basic Design Services	Hours	Hours	Hours	Hours	Hours	Hours	Hours	Hours	Hours	Hours	Hours	Hours	Hours	-
Task - 60% Design														
1	PM project, permits, schedule, invoicing and communications. Also include any site specific safety permit and plan.	3.00	0.00	0.00	0.00	0.00	0.00	0.00						3.00
2	Oversee and process all survey data.	0.00	5.00	0.00	0.00	0.00	0.00	0.00						5.00
3	Prepare deliverable, sheet out and clean up	0.00	0.00	12.00	0.00	0.00	0.00	0.00						12.00
4	Project coordination and support	0.00	0.00	0.00	1.00	0.00	0.00	0.00						1.00
5	Contingency for test holes to address, design elements that would cause potential utility conflicts, and unforeseen field conditions (bank of test holes)	0.00	0.00	0.00	0.00	0.00	20.00	0.00						20.00
6	Survey all discovered utility information	0.00	0.00	0.00	0.00	0.00	0.00	5.00						5.00
7		0.00	0.00	0.00	0.00	0.00	0.00	0.00						0.00
8		0.00	0.00	0.00	0.00	0.00	0.00	0.00						0.00
9		0.00	0.00	0.00	0.00	0.00	0.00	0.00						0.00
10		0.00	0.00	0.00	0.00	0.00	0.00	0.00						0.00
11		0.00	0.00	0.00	0.00	0.00	0.00	0.00						0.00
12		0.00	0.00	0.00	0.00	0.00	0.00	0.00						0.00
Subtotal Hours		3.00	5.00	12.00	1.00	0.00	20.00	5.00	0.00	0.00	0.00	0.00	0.00	46.00
Rate		\$ 57.69	\$ 38.13	\$ 32.00	\$ 29.38	\$ 66.67	\$ 79.17	\$ 56.26	\$ -	\$ -	\$ -	\$ -	\$ -	\$ -
Subtotal Direct Labor		\$ 173.07	\$ 190.65	\$ 384.00	\$ 29.38	\$ -	\$ 1,583.40	\$ 281.30	\$ -	\$ -	\$ -	\$ -	\$ -	\$ 2,641.80
Subtotal Burdened Labor @			2.75											\$ 7,264.95

Project Fee Proposal - Hensel Phelps Team														
Main Terminal Curbside Expansion - MCE														
HCAA Project Number 8230-18														
3/29/2019														

60% Design Fee

Subtotal Hours	0.00	0.00	0.00	0.00	0.00	0.00	0.00	0.00	0.00	0.00	0.00	0.00	0.00	0.00	0.00
Rate	\$ 48.27	\$ 37.93	\$ 36.21	\$ 56.76	\$ 47.14	\$ 41.19	\$ 37.99	\$ -	\$ -	\$ -	\$ -	\$ -	\$ -	\$ -	\$ -
Subtotal Direct Labor	\$ -	\$ -	\$ -	\$ -	\$ -	\$ -	\$ -	\$ -	\$ -	\$ -	\$ -	\$ -	\$ -	\$ -	\$ -
Subtotal Burdened Labor @		2.90													\$ -

Project Fee Proposal - Hensel Phelps Team															
Main Terminal Curbside Expansion - Henderson (Arch Lighting)															
HCAA Project Number 8240-19															
3/29/2019															
Scope/Task		Principal	Director	Design Dir	Designer-G	Designer-K	Admin							-	Total
Basic Design Services		Hours	Hours	Hours	Hours	Hours	Hours	Hours	Hours	Hours	Hours	Hours	Hours	Hours	
Task - 60% Design															
1 regular coord meeting with HNTB/Engg (assumes shared mtgs will discuss various spaces)															0.00
2 Design Coordination with Engg															0.00
3															0.00
4															0.00
5															0.00
6															0.00
7															0.00
8															0.00
9															0.00
10															0.00
11															0.00
Subtotal Hours		0.00	0.00	0.00	0.00	0.00	0.00	0.00	0.00	0.00	0.00	0.00	0.00	0.00	0.00
Rate		\$ 175.00	\$ 145.00	\$ 150.00	\$ 130.00	\$ 120.00	\$ 20.00	\$ -	\$ -	\$ -	\$ -	\$ -	\$ -	\$ -	\$ -
Subtotal Direct Labor		\$ -	\$ -	\$ -	\$ -	\$ -	\$ -	\$ -	\$ -	\$ -	\$ -	\$ -	\$ -	\$ -	\$ -
Subtotal Burdened Labor @			2.90												\$ -

Project Fee Proposal - Hensel Phelps Team															
Main Terminal Curbside Expansion - Henderson (Code Consulting)															
HCAA Project Number 8240-19															
3/29/2019															
Scope/Task		Principal	Director	Sr. Code Cons	Code Cons	BIM/CAD	Admin							-	Total
Basic Design Services		Hours	Hours	Hours	Hours	Hours	Hours	Hours	Hours	Hours	Hours	Hours	Hours	Hours	
Task - 60% Design															
1 Code compliance assessment		0.00	1.54	6.16	0.00	0.00									7.70
2 revise code narrative		0.00	0.77	1.54	6.16	0.00									8.47
3 egress/life safety drawings - offices		0.00	0.77	3.08	0.00	6.16									10.01
4 egress/life safety drawings - parking garage		0.00	0.77	3.08	0.00	12.32									16.17
5 meetings (design team)		0.00	0.00	3.08	0.00	0.00									3.08
6 general code consulting		0.00	0.00	12.32	0.00	0.00									12.32
7 variance for mechanical ventilation		0.00	0.00	3.08	0.00	0.00									3.08
8		0.00	0.00	0.00	0.00	0.00									0.00
9		0.00	0.00	0.00	0.00	0.00									0.00
10		0.00	0.00	0.00	0.00	0.00									0.00
11		0.00	0.00	0.00	0.00	0.00									0.00
Subtotal Hours		0.00	3.85	32.34	6.16	18.48	0.00	0.00	0.00	0.00	0.00	0.00	0.00	0.00	60.83
Rate		\$ 72.16	\$ 60.90	\$ 60.10	\$ 34.00	\$ 18.50	\$ 20.00	\$ -	\$ -	\$ -	\$ -	\$ -	\$ -	\$ -	\$ -
Subtotal Direct Labor		\$ -	\$ 234.47	\$ 1,943.63	\$ 209.44	\$ 341.88	\$ -	\$ -	\$ -	\$ -	\$ -	\$ -	\$ -	\$ -	\$ 2,729.42
Subtotal Burdened Labor @			2.90												\$ 7,915.32

Project Fee Proposal - Hensel Phelps Team															
Main Terminal Curbside Expansion - TLC															
HCAA Project Number 8240-19															
3/29/2019															
Scope/Task		Principal	-	Sr. Engineer	Engineer II	Engineer I	Admin	Sr. Tech	Tech II	CAD Tech				-	Total

60% Design Fee

Basic Design Services		Hours	Hours	Hours	Hours	Hours	Hours	Hours	Hours	Hours	Hours	Hours	Hours	Hours	Hours
Task - 60% Design															
1	Evaluation/relocation existing infra.	0.00	0.00	0.00	0.00	0.00	0.00	0.90	0.00	0.00					0.90
2	Site Walk and Field Verification	0.00	0.00	0.00	0.00	0.00	0.00	0.00	0.45	0.00					0.45
3	Design Meetings	0.00	0.00	0.00	0.90	0.00	0.00	0.00	0.00	0.00					0.90
4	Calculations	0.00	0.00	0.00	0.00	0.45	0.00	0.00	0.00	0.00					0.45
5	Drawing Development	0.00	0.00	0.00	0.00	0.45	0.00	0.00	0.00	0.90					1.35
6	Specification Development	0.00	0.00	0.00	0.00	0.00	0.00	0.45	0.00	0.00					0.45
7	Coordination	0.00	0.00	0.00	0.45	0.00	0.00	0.00	0.00	0.00					0.45
8	Quality Control	0.00	0.00	0.00	0.00	0.00	0.00	0.45	0.00	0.00					0.45
9	Response to Comments	0.00	0.00	0.00	0.45	0.00	0.00	0.00	0.00	0.00					0.45
10	Project Management	6.50	0.00	0.00	0.00	0.00	0.00	0.00	0.00	0.00					6.50
11		0.00	0.00	0.00	0.00	0.00	0.00	0.00	0.00	0.00					0.00
Subtotal Hours		6.50	0.00	0.00	1.80	0.90	0.00	1.80	0.45	0.90	0.00	0.00	0.00	0.00	12.35
Rate		\$ 77.88	\$ -	\$ 52.88	\$ 42.09	\$ 36.63	\$ 25.72	\$ 62.50	\$ 32.69	\$ 25.50	\$ -	\$ -	\$ -	\$ -	
Subtotal Direct Labor		\$ 506.22	\$ -	\$ -	\$ 75.76	\$ 32.97	\$ -	\$ 112.50	\$ 14.71	\$ 22.95	\$ -	\$ -	\$ -	\$ -	\$ 765.11
Subtotal Burdened Labor @			2.91												\$ 2,226.47

Project Fee Proposal - Hensel Phelps Team															
Main Terminal Curbside Expansion - LA Design															
HCAA Project Number 8240-19															
3/29/2019															
Scope/Task	Sr Designer	Ldsp Arc	Sr Ldsp Arc	Ch Scientist	Hours	Hours	Hours	Hours	Hours	Hours	Hours	Hours	Hours	Hours	Total
Basic Design Services															
Task - 60% Design															
1	Kickoff mtg, site visit mtg, field verify veg	0.00	0.00	3.08	0.00										3.08
2	Code Info / Tree Review	0.00	0.00	1.54	0.00										1.54
3	COT / Research	0.00	0.00	0.00	0.00										0.00
4	Base Map Set Up-Layout Sheets	0.00	0.00	0.00	3.08										3.08
5	Design Development Plans	0.00	0.00	0.00	0.00										0.00
6	(1 Sheets- no irrigation this phase)	12.32	0.00	9.24	9.24										30.80
7	Probable Cost	0.00	0.00	0.00	0.00										0.00
8	Specifications Notes Details	0.00	0.00	3.08	3.08										6.16
9	Written Response to Comments	0.00	0.00	1.54	1.54										3.08
10	QA QC Reviews	0.00	2.31	2.31	0.00										4.62
11	Design Meeting- 1 and Coordination	0.00	0.00	2.31	2.31										4.62
Subtotal Hours		12.32	2.31	23.10	19.25	0.00	0.00	0.00	0.00	0.00	0.00	0.00	0.00	0.00	56.98
Rate		\$ 32.78	\$ 46.00	\$ 55.00	\$ 55.00	\$ 20.00	\$ 20.00	\$ 20.00	\$ -	\$ -	\$ -	\$ -	\$ -	\$ -	
Subtotal Direct Labor		\$ 403.85	\$ 106.26	\$ 1,270.50	\$ 1,058.75	\$ -	\$ -	\$ -	\$ -	\$ -	\$ -	\$ -	\$ -	\$ -	\$ 2,839.36
Subtotal Burdened Labor @			2.42												\$ 6,871.25

Project Fee Proposal - Hensel Phelps Team															
Main Terminal Curbside Expansion - Voltair															
HCAA Project Number 8240-19															
3/29/2019															
Scope/Task	Principal	Electrical Director	Senior Electrical Engineer	Electrical Engineer II	Sr. Electrical Designer	Electrical Designer	Mechanical EOR	Mechanical Engineer II	Mechanical Engineer I	Sr Fire Protection Designer	Senior Plumbing Designer	BIM Coordinator	Clerical	Hours	Total
Basic Design Services															
Task - 60% Design															
1	Weekly Design Meetings		3.65	3.65	3.65				3.65				3.65		18.25
2	Project Setup / Weekly Updates (BIM)											18.25			18.25
3	Site Investigations			2.92	2.92				5.11						10.95
4	Electrical Power Design		3.65	14.60	13.14	16.06	18.25								65.70
5	Fire Protection Design						1.46		16.06	14.60					32.12
6	Fire Alarm Design		2.92		10.95										13.87
7	Lighting Design		8.03	14.60	16.79										39.42
8	HVAC Design						36.50	43.80	52.56						132.86
9	Plumbing Design								62.78		37.96				100.74

90% Design Fee

Main Terminal Curbside Expansion, New Energy Plant and Related Work 90% Design

Project Fee Proposal - Hensel Phelps Team

Main Terminal Curbside Expansion - Hensel Phelps

HCAA Project Number 8230-18

3/29/2019

Scope/Task	Proj Mgr	Precon Mgr	Gen Sup	Proj Sup	Area Sup	Proj Engr	Schedule	Sr. Estimator	Lead Estimator	VDC Mgr	VDC Engr			Total	
	Hours	Hours	Hours	Hours	Hours	Hours	Hours	Hours	Hours	Hours	Hours		Hours		
Basic Design Services															
Task - 90% Design															
1	Laser Scanning management													0.00	
2	BIM Revit model management									5.00	5.00			10.00	
3	Manage Site survey and data collection									5.00	5.00			10.00	
4	Budget Verification							40	40					80.00	
5	Set up project cost estimate													0.00	
8	Outreach events within the Community	10	10					10	10					40.00	
9	Develop project schedule													0.00	
15	Constructability Reviews	10		5	10									25.00	
17	Trend Estimating							10	10					20.00	
18	Meetings	10	10	5	10									35.00	
19	Document Control					10								10.00	
22	Maintain project schedule	10		5	40		80							135.00	
25	Coordinate surveys													0.00	
26	Reports					10								10.00	
	Subtotal Hours	40.00	20.00	15.00	60.00	0.00	20.00	80.00	60.00	60.00	10.00	10.00	0.00	0.00	375.00
	Rate	\$ 44.51	\$ 58.24	\$ 57.51	\$ 51.88	\$ 41.62	\$ 36.13	\$ 49.13	\$ 45.66	\$ 39.02	\$ 41.62	\$ 34.39			
	Subtotal Direct Labor	\$ 1,780.40	\$ 1,164.80	\$ 862.65	\$ 3,112.80	\$ -	\$ 722.60	\$ 3,930.40	\$ 2,739.60	\$ 2,341.20	\$ 416.20	\$ 343.90		\$ -	\$ 17,414.55
	Subtotal Burdened Labor @		2.72											\$ 47,367.58	

Main Terminal Curbside Expansion - Beck

HCAA Project Number 8230-18

3/29/2019

Scope/Task	Sr. Arch. PM	Arch. PM (Mod)	Arch. 3	Arch 3 (2)	VBG 6	VBG 4	PM 6	PM 4	SUP 3	PCM 7	PAM			Total
	Hours	Hours	Hours	Hours	Hours	Hours	Hours	Hours	Hours	Hours	Hours		Hours	
Basic Design Services														
####														
1	Existing Cond Assessment (Civil)													0.00
2	Existing Cond Assessment (Building)													0.00
3	BIM/Revit Modeling					60.00	60.00	20.00						140.00
4	City of Tampa Permitting													0.00
5	Design Coordination Services						20.00							20.00
6	QA/QC Services													0.00
7	Precon - Cost Estimating, Budgeting													0.00
8	Project Administration													0.00
9														0.00
10														0.00
	Subtotal Hours	0.00	0.00	0.00	0.00	60.00	60.00	40.00	0.00	0.00	0.00	0.00	0.00	160.00
	Rate	\$ 66.20	\$ 67.02	\$ 39.18	\$ 38.16	\$ 67.32	\$ 65.23	\$ 90.43	\$ 58.47	\$ 45.68	\$ 93.15	\$ 43.27		
	Subtotal Direct Labor	\$ -	\$ -	\$ -	\$ -	\$ 4,039.38	\$ 3,913.86	\$ 3,617.12	\$ -	\$ -	\$ -	\$ -	\$ -	\$ 11,570.36
	Subtotal Burdened Labor @		3.00											\$ 34,711.08

Project Fee Proposal - Hensel Phelps Team

Main Terminal Curbside Expansion - HNTB Arch

HCAA Project Number 8230-18

3/29/2019

Scope/Task	Arch PM	Arch Des. Dir	Arch Sr. Des.	Arch Sr. PA	Arch Jr. Des.	Tech. Staff		Admin	QC					Total
	Hours	Hours	Hours	Hours	Hours	Hours	Hours	Hours	Hours	Hours	Hours	Hours	Hours	
Basic Design Services														

90% Design Fee

10			0.00	0.00	0.00	0.00	0.00	0.00	0.00	0.00	0.00	0.00	0.00	0.00	0.00	0.00
11			0.00	0.00	0.00	0.00	0.00	0.00	0.00	0.00	0.00	0.00	0.00	0.00	0.00	0.00
		Subtotal Hours	24.65	55.25	0.00	0.00	105.40	8.50	0.00	0.00	0.00	0.00	0.00	0.00	0.00	193.80
		Rate	\$ 70.67	\$ 36.06	\$ -	\$ 30.05	\$ 27.30	\$ 25.50	\$ -	\$ -	\$ -	\$ -	\$ -	\$ -	\$ -	\$ -
		Subtotal Direct Labor	\$ 1,742.02	\$ 1,992.32	\$ -	\$ -	\$ 2,877.42	\$ 216.75	\$ -	\$ -	\$ -	\$ -	\$ -	\$ -	\$ -	\$ 6,828.50
		Subtotal Burdened Labor @		3.00												\$ 20,485.50

Project Fee Proposal - Hensel Phelps Team															
Main Terminal Curbside Expansion - Ayres															
HCAA Project Number 8240-19															
3/29/2019															
Scope/Task		Project Manager	Principal Engineer	Senior Engineer	Technical Engineer	Engineer	Interior Designer	Engineering Technician	Secretary	Clerical	Engineering Technician				Total
		Hours	Hours	Hours	Hours	Hours	Hours	Hours	Hours	Hours	Hours	Hours	Hours	Hours	Hours
Basic Design Services															
Task - 90% Design															
1	Geotechnical	16	10	13	1	1	7.00	3.00	1.00	6.75					58.75
2															0.00
3															0.00
4															0.00
5															0.00
6															0.00
7															0.00
8															0.00
9															0.00
10															0.00
11															0.00
	Subtotal Hours	16.00	10.00	13.00	1.00	1.00	7.00	3.00	1.00	6.75	0.00	0.00		0.00	58.75
	Rate	\$ 60.10	\$ 64.90	\$ 56.97	\$ 36.06	\$ 25.96	\$ 29.81	\$ 25.00	\$ 19.00	\$ 16.00	\$ -	\$ -		\$ -	
	Subtotal Direct Labor	\$ 961.60	\$ 649.00	\$ 740.61	\$ 36.06	\$ 25.96	\$ 208.67	\$ 75.00	\$ 19.00	\$ 108.00	\$ -	\$ -		\$ -	\$ 2,823.90
	Subtotal Burdened Labor @		3.00												\$ 8,471.70

Project Fee Proposal - Hensel Phelps Team															
Main Terminal Curbside Expansion - Henderson (Acoustics)															
HCAA Project Number 8240-19															
3/29/2019															
Scope/Task		Director	Aco Cons	Jr Aco Cons	LGT Director	GT Design D	Designer-G	Designer-K							Total
		Hours	Hours	Hours	Hours	Hours	Hours	Hours	Hours	Hours	Hours	Hours	Hours	Hours	Hours
Basic Design Services															
Task - 90% Design															
1	Acoustics														0.00
2															0.00
3															0.00
4															0.00
5															0.00
6															0.00
7															0.00
8															0.00
9															0.00
10															0.00
11															0.00
	Subtotal Hours	0.00	0.00	0.00	0.00	0.00	0.00	0.00	0.00	0.00	0.00	0.00	0.00	0.00	0.00
	Rate	\$ 48.27	\$ 37.93	\$ 36.21	\$ 56.76	\$ 47.14	\$ 41.19	\$ 37.99	\$ -	\$ -	\$ -	\$ -	\$ -	\$ -	\$ -
	Subtotal Direct Labor	\$ -	\$ -	\$ -	\$ -	\$ -	\$ -	\$ -	\$ -	\$ -	\$ -	\$ -	\$ -	\$ -	\$ -
	Subtotal Burdened Labor @		2.90												\$ -

Construction Administration Fee

Main Terminal Curbside Expansion, New Energy Plant and Related Work Construction Admin

Project Fee Proposal - Hensel Phelps Team															
Main Terminal Curbside Expansion - HNTB Arch															
HCAA Project Number 8230-18															
3/29/2019															
Scope/Task		Arch PM	Arch Des. Dir	Arch Sr. Des.	Arch Sr. PA	Arch Jr. Des.	Tech. Staff		Admin	QC					Total
		Hours	Hours	Hours	Hours	Hours	Hours	Hours	Hours	Hours	Hours	Hours	Hours	Hours	Hours
Basic Design Services															
Task - CA Services HNTB															
1	Consultant Coordination			179											179.00
2	BIM Coordination														0.00
3	Field Work			179											179.00
4	Submittal Review			471		200									671.00
5	RFI's			235		200									435.00
6	Supplemental Information					460									460.00
7															0.00
8															0.00
9															0.00
10															0.00
11															0.00
	Subtotal Hours	0.00	0.00	1,064.00	0.00	860.00	0.00	0.00	0.00	0.00	0.00	0.00	0.00	0.00	1,924.00
	Rate	\$ 70.00	\$ 80.00	\$ 43.50	\$ 46.00	\$ 27.00	\$ 25.00		\$ 35.50	\$ 93.00					
	Subtotal Direct Labor	\$ -	\$ -	\$ 46,284.00	\$ -	\$ 23,220.00	\$ -	\$ -	\$ -	\$ -	\$ -	\$ -	\$ -	\$ -	\$ 69,504.00
	Subtotal Burdened Labor @		2.84												\$ 197,391.36

Construction Administration Fee

Project Fee Proposal - Hensel Phelps Team															
Main Terminal Curbside Expansion - Ayres															
HCAA Project Number 8240-19															
3/29/2019															
Scope/Task		Project Manager	Principal Engineer	Senior Engineer	Technical Engineer	Engineer Intern	Senior Designer	Engineering Technician	Secretary/Clerical	Engineering Technician				-	Total
		Hours	Hours	Hours	Hours	Hours	Hours	Hours	Hours	Hours	Hours	Hours	Hours	Hours	Hours
Basic Design Services															
Task - CA Services HNTB															
1	Geotechnical														0.00
2															0.00
3															0.00
4															0.00
5															0.00
6															0.00
7															0.00
8															0.00
9															0.00
10															0.00
11															0.00
	Subtotal Hours	0.00	0.00	0.00	0.00	0.00	0.00	0.00	0.00	0.00	0.00	0.00	0.00	0.00	0.00
	Rate	\$ 60.10	\$ 64.90	\$ 56.97	\$ 36.06	\$ 25.96	\$ 29.81	\$ 25.00	\$ 19.00	\$ 16.00	\$ -	\$ -	\$ -	\$ -	\$ -
	Subtotal Direct Labor	\$ -	\$ -	\$ -	\$ -	\$ -	\$ -	\$ -	\$ -	\$ -	\$ -	\$ -	\$ -	\$ -	\$ -
	Subtotal Burdened Labor @		3.00												\$ -

Project Fee Proposal - Hensel Phelps Team															
Main Terminal Curbside Expansion - Henderson (Acoustics)															
HCAA Project Number 8240-19															
3/29/2019															
Scope/Task		Director	Aco Cons	Jr Aco Cons	LGT Director	GT Design D	Designer-G	Designer-K						-	Total
		Hours	Hours	Hours	Hours	Hours	Hours	Hours	Hours	Hours	Hours	Hours	Hours	Hours	Hours
Basic Design Services															
Task - CA Services HNTB															
1	Acoustics														0.00
2															0.00
3															0.00
4															0.00
5															0.00
6															0.00
7															0.00
8															0.00
9															0.00
10															0.00
11															0.00
	Subtotal Hours	0.00	0.00	0.00	0.00	0.00	0.00	0.00	0.00	0.00	0.00	0.00	0.00	0.00	0.00
	Rate	\$ 48.27	\$ 37.93	\$ 36.21	\$ 56.76	\$ 47.14	\$ 41.19	\$ 37.99	\$ -	\$ -	\$ -	\$ -	\$ -	\$ -	\$ -
	Subtotal Direct Labor	\$ -	\$ -	\$ -	\$ -	\$ -	\$ -	\$ -	\$ -	\$ -	\$ -	\$ -	\$ -	\$ -	\$ -
	Subtotal Burdened Labor @		2.90												\$ -

Project Fee Proposal - Hensel Phelps Team															
Main Terminal Curbside Expansion - Henderson (Arch Lighting)															
HCAA Project Number 8240-19															
3/29/2019															
Scope/Task		Principal	Director	Design Dir	Designer-G	Designer-K	Admin							-	Total
		Hours	Hours	Hours	Hours	Hours	Hours	Hours	Hours	Hours	Hours	Hours	Hours	Hours	Hours
Basic Design Services															
Task - CA Services HNTB															
1															0.00
2															0.00
3															0.00
4															0.00

Construction Administration Fee

Project Fee Proposal - Hensel Phelps Team															
Main Terminal Curbside Expansion - LA Design															
HCAA Project Number 8240-19															
3/29/2019															
Scope/Task		Sr Designer	Ldsp Arc	Sr Ldsp Arc	Ch Scientist									-	Total
		Hours	Hours	Hours	Hours	Hours	Hours	Hours	Hours	Hours	Hours	Hours	Hours	Hours	Hours
Basic Design Services															
Task - CA Services HNTB															
1	Review Submittals	8.00	0.00	12.00	12.00										32.00
2	Response to RFIs	8.00		12.00	12.00										32.00
3	Plant Approvals (Approvals by Photos per Plans only)		0.00	8.00											8.00
4			0.00	0.00	0.00										0.00
5	Construction Admin														0.00
6	Site Visits - 3 Landscape			18.00	12.00										30.00
7	Site Visits -3 Irrigation	18.00													18.00
8															0.00
9															0.00
10															0.00
11															0.00
	Subtotal Hours	34.00	0.00	50.00	36.00	0.00	0.00	0.00	0.00	0.00	0.00	0.00	0.00	0.00	120.00
	Rate	\$ 32.78	\$ 46.00	\$ 55.00	\$ 55.00	\$ 20.00	\$ 20.00	\$ 20.00	\$ -	\$ -	\$ -	\$ -	\$ -	\$ -	\$ -
	Subtotal Direct Labor	\$ 1,114.52	\$ -	\$ 2,750.00	\$ 1,980.00	\$ -	\$ -	\$ -	\$ -	\$ -	\$ -	\$ -	\$ -	\$ -	\$ 5,844.52
	Subtotal Burdened Labor @		2.42												\$ 14,143.74

Project Fee Proposal - Hensel Phelps Team															
Main Terminal Curbside Expansion - Voltair															
HCAA Project Number 8240-19															
3/29/2019															
Scope/Task		Principal	Electrical Director	Senior Electrical Engineer	Electrical Engineer II	Sr. Electrical Designer	Electrical Designer	Mechanical EOR	Mechanical Engineer II	Mechanical Engineer I	Sr Fire Protection Designer	Senior Plumbing Designer	BIM Coordinator	Clerical	Total
		Hours	Hours	Hours	Hours	Hours	Hours	Hours	Hours	Hours	Hours	Hours	Hours	Hours	Hours
Basic Design Services															
Task - CA Services HNTB															
1	RFI Review And Response		7.00	18.00	23.00	7.00	7.00	18.00	63.00	58.00	3.00	48.00		8.00	260.00
2	Submittal Review		11.00	25.00	31.00	7.00		4.00	63.00	72.00	17.00	50.00		8.00	288.00
3	Owner Submittal Review Meetings		7.00	14.00					7.00						28.00
4	Bi Weekly OAC Meetings	5.00		29.00	18.00			14.00	4.00			14.00			84.00
5	Bi Weekly Site Construction Obs			29.00	22.00				22.00	22.00					95.00
6	Bi Weekly Field Reports			13.00	13.00				14.00	14.00					54.00
7	Permitting	4.00	8.00	7.00		7.00	7.00	5.00	14.00	14.00		14.00			80.00
8															0.00
9															0.00
10															0.00
11															0.00
12															0.00
13															0.00
14															0.00
15															0.00
16															0.00
	Subtotal Hours	9.00	33.00	135.00	107.00	21.00	14.00	41.00	187.00	180.00	20.00	126.00	0.00	16.00	889.00
	Rate	\$ 85.72	\$ 69.33	\$ 58.19	\$ 40.56	\$ 43.99	\$ 40.55	\$ 53.50	\$ 40.81	\$ 32.83	\$ 48.20	\$ 48.20	\$ 43.99	\$ 29.38	\$ -
	Subtotal Direct Labor	\$ 771.48	\$ 2,287.89	\$ 7,855.65	\$ 4,339.92	\$ 923.79	\$ 567.70	\$ 2,193.50	\$ 7,631.47	\$ 5,909.40	\$ 964.00	\$ 6,073.20	\$ -	\$ 470.08	\$ 39,988.08
	Subtotal Burdened Labor @		2.30												\$ 91,972.58



HENSEL PHELPS

Plan. Build. Manage.

6557 Hazeltine National Drive
Suite One
Orlando, FL 32822
407.856.2400

May 21, 2019

Hillsborough County Aviation Authority
Attn: Brian Rumble
Program Manager
Tampa International Airport

Subject: Request for Change Order CE#004 – Owner Directive – Conditioned Blue Side
Pedestrian Bridge
8230 18 – MTCE Project
Tampa International Airport

Dear Brian:

Hensel Phelps Construction Co. is hereby submitting Change Estimate #004. Included are costs to fully enclose and condition the new Blue Side Transfer Level pedestrian bridge and construct a new lobby in the long-term garage per direction from the Owner. This scope was not included in the original design scope for the MTCE project.

The total cost is \$150,844.10 including all documentation to substantiate the additional cost requested.

Any costs associated with CA will be included in the Part 2 Agreement as part of a separate change estimate incorporated into the GMP proposal.

Please do not hesitate to contact the project team with any questions or concerns.

Sincerely,
HENSEL PHELPS CONSTRUCTION CO.

Drew Krizman

Drew Krizman
Program Manager for Construction

c: 8016169, DK, SG

Hensel Phelps Reimbursable Calculation						
			Manhours			
Vehicles			30%	60%	90%	100%
Project Manager			40	30	40	30
Preconstruction Manager			20	30	20	-
General Superintendent			30	20	15	15
Project Superintendent			40	40	60	40
Area Superintendent			-	-	-	-
Sr. Estimator			80	70	60	40
VDC Manager			30	20	10	10
			240	210	205	135
Manmonths			1.38	1.21	1.18	0.78
Vehicle Reimbursable @ \$1250/month			\$ 1,731.10	\$ 1,514.71	\$ 1,478.65	\$ 973.74
Project Engineer			20	20	20	20
Lead Estimator			100	60	60	30
			120	80	80	50
			0.69	0.46	0.46	0.29
Vehicle Reimbursable @ \$700/month			\$ 484.71	\$ 323.14	\$ 323.14	\$ 201.96
Cell Phones @ \$82/month			\$ 170.34	\$ 137.22	\$ 134.85	\$ 87.54
MEP Discovery			\$ 15,000.00	\$ 2,500.00	\$ -	\$ -
Plan Check Fees			\$ -	\$ -	\$ 1,000.00	\$ 1,000.00
Subtotal Reimbursables			\$ 17,386.15	\$ 4,475.07	\$ 2,936.64	\$ 2,263.24

CE: 004**Change Estimate Summary****HENSEL PHELPS**
Plan. Build. Manage.8230 18 - MTCE Project
Tampa International Airport

Company	Description of Scope	Change Estimate Totals	
HNTB	Curtainwall enclosed pedestrian bridge, lobby room in the LTPG, new air handling room, fire separation doors and walls, additional bridge structure to resist added wind lateral loads, and interior finish design.	\$	55,343.62
TLC Engineering	New HVAC air conditioning system, air handling equipment, and ductwork and chilled and hot water piping	\$	25,189.89
Henderson Consulting	Life safety consulting to analyze fire separation and code report to obtain code approval from City of Tampa	\$	61,821.04
Voltair Electrical	Electrical design for all new added elements for enclosed bridge	\$	8,489.55
		\$	-
		\$	-
		\$	-
		\$	-
		\$	-
		\$	-
SUBTOTAL:		\$	150,844.10

INITIATING DOCUMENTS

Owner Directive

In the original MTCE contractual scope of work and in the master plan documents the new pedestrian bridge from the Long Term Parking Garage (LTPG) to the new Blue Side was to be an open air bridge as the existing pedestrian bridges are today. The design fees were based on that assumption. HCAA has instructed the HP team that this bridge now needs to be fully enclosed and a new lobby is to be created in the LTPG.

Enclosed Pedestrian Bridge – Blue Side

In the original MTCE contractual scope of work and in the master plan documents the new pedestrian bridge from the Long-Term Parking Garage (LTPG) to the new Blue Side was to be an *open-air* bridge as the existing pedestrian bridges are today. The design fees were based on that assumption.

HCAA has instructed the HP team that this bridge needs to be fully enclosed and a new lobby is to be created in the LTPG.

This project would be treated as a direct extension of the Blue Side Vertical Circulation Building project (8230-18-BSC) and be designed, bid and built at the same time with the Blue Side enabling project package.

This change has several design and building code implications. A fully enclosed bridge has substantially more wind exposure and therefore increases the lateral structural wind loads that must be designed to accommodate the wind load. The open-air bridge had an exposed structure with a railing, the enclosed bridge will now require a fully enclosed building and must be watertight requiring complete curtainwall detailing. HVAC engineering is required and will require an air handling room and equipment placed in the LTPG as there is insufficient head room to bring ductwork from the Blue Side vertical circulation/main terminal buildings. A specialized ductwork system will be supply air from below the bridge floor into the bridge. This enclosed Bridge also requires a fire separation with two sets of 2-hour fire rated doors and short 2 hour rated side walls the last 10 feet adjacent to the LTPG to achieve the required fire separation between the main terminal building and the LTPG. This requirement requires a variance and additional fire life safety analysis and report to satisfy the City of Tampa Building Department.

The scope of the project includes:

- Curtainwall enclosed pedestrian bridge, lobby room in the LTPG, new air handling room, fire separation doors and walls.
- Additional bridge structure to resist added wind lateral loads.
- New HVAC air conditioning system, air handling equipment, and ductwork and chilled and hot water piping.
- Life safety consulting to analyze fire separation and code report to obtain code approval from City of Tampa.
- Interior finish design in the enclosed bridge.

The scope does not include any other modifications such as moving walks or a larger lobby in the LTPG.

Disciplines involved:

- Architecture, Structural engineering, Mechanical engineering, Electrical engineering, Fire /life safety code analysis, Interior design.

This design will be reflected in the 30%, 60%, 90% and 100% design submittals of the Blue Side project and construction package.

SUBCONTRACTOR PRICING

- 1 HNTB
- 2 TLC Engineering
- 3 Henderson Consulting
- 4 Voltair Electrical

Main Terminal Curbside Expansion, New Energy Plant and Related Work

HCAA Project Numbers 8230-18-BCS, 8230-18-RCS, 8200-18, 8205-18-CEP, 8205-18-CEP, 8205-18-LDB, 8900-18, 8240-19

3/13/2019

Basic Design Services		30%	60%	90%	100%	Total	Construction	Total	W/MBE %	% W/MBE	% Construction
Engineering & Preconstruction Services		Design Dev.	Design Dev.	Const. Docs	Final Docs	Part 1	Administration		of Fee	Goal	Cost
Main Terminal Curbside Expansion - HNTB Struct		\$ -	\$ -	\$ 14,643.84	\$ 5,966.22	\$ 20,610.05	\$ 4,070.43	\$ 24,680.48			
Main Terminal Curbside Expansion - HNTB Arch		\$ -	\$ -	\$ 24,681.05	\$ 10,052.52	\$ 34,733.57	\$ 6,858.60	\$ 41,592.17			
Main Terminal Curbside Expansion - TLC		\$ -	\$ -	\$ 15,213.97	\$ 9,975.92	\$ 25,189.89	\$ 5,863.30	\$ 31,053.19			
Main Terminal Curbside Expansion - Henderson Consulting		\$ -	\$ -	\$ 41,220.89	\$ 20,600.15	\$ 61,821.04	\$ -	\$ 61,821.04			
Main Terminal Curbside Expansion - Voltair		\$ -	\$ -	\$ 5,183.49	\$ 3,306.07	\$ 8,489.55	\$ 1,654.90	\$ 10,144.45			
Design Phase Sub Total		\$ -	\$ -	\$ 100,943.24	\$ 49,900.87	\$ 150,844.10	\$ 18,447.23	\$ 169,291.33			

CA cost will be incorporated into Part 2 Agreement GMP proposal

8230 18 MTCE Project
Tampa International Airport

CE 004

HNTB

Curtainwall enclosed pedestrian bridge, lobby room in the LTPG, new air handling room, fire separation doors and walls, additional bridge structure to resist added wind lateral loads, and interior finish design.

90% Design Fee

Main Terminal Curbside Expansion, New Energy Plant and Related Work 90% Design

Project Fee Proposal - Hensel Phelps Team											
Main Terminal Curbside Expansion - HNTB Struct											
HCAA Project Number 8230-18											
3/13/2019											
Scope/Task		Sr. Struct	Proj Struct	Struct E.	Sr. Tech	Tech.	Admin				Total
		Hours	Hours	Hours	Hours	Hours	Hours	Hours	Hours	Hours	
Basic Design Services											
Task - 90% Design											
1	Blueside - Lobby Building and Ped Links										0.00
2	Blueside - Curbside Roadway Canopies (Mng MCE)										0.00
3	Blueside - Pedestrian Bridge Enclosure	3	51	33		32					119.00
4											0.00
5											0.00
6											0.00
7											0.00
8											0.00
9											0.00
10											0.00
11											0.00
	Subtotal Hours	3.00	51.00	33.00	0.00	32.00	0.00	0.00	0.00	0.00	119.00
	Rate	\$ 85.31	\$ 52.50	\$ 38.85	\$ 40.95	\$ 29.40	\$ 21.00				
	Subtotal Direct Labor	\$ 255.93	\$ 2,677.50	\$ 1,282.05	\$ -	\$ 940.80	\$ -	\$ -	\$ -	\$ -	\$ 5,156.28
	Subtotal Burdened Labor @		2.84								\$ 14,643.84

100% Design Fee

Main Terminal Curbside Expansion, New Energy Plant and Related Work 100% Design

Project Fee Proposal - Hensel Phelps Team											
Main Terminal Curbside Expansion - HNTB Struct											
HCAA Project Number 8230-18											
3/13/2019											
Scope/Task		Sr. Struct	Proj Struct	Struct E.	Sr. Tech	Tech.	Admin				Total
Basic Design Services		Hours	Hours	Hours	Hours	Hours	Hours	Hours	Hours	Hours	
Task - 100% Design											
1	Blueside - Lobby Building and Ped Links										0.00
2	Blueside - Curbside Roadway Canopies (Mng MCE)										0.00
3	Blueside - Pedestrian Bridge Enclosure	3	21	7		16					47.00
4											0.00
5											0.00
6											0.00
7											0.00
8											0.00
9											0.00
10											0.00
11											0.00
Subtotal Hours		3.00	21.00	7.00	0.00	16.00	0.00	0.00	0.00	0.00	47.00
Rate		\$ 85.31	\$ 52.50	\$ 38.85	\$ 40.95	\$ 29.40	\$ 21.00				
Subtotal Direct Labor		\$ 255.93	\$ 1,102.50	\$ 271.95	\$ -	\$ 470.40	\$ -	\$ -	\$ -	\$ -	\$ 2,100.78
Subtotal Burdened Labor @			2.84								\$ 5,966.22

Construction Administration Fee

Main Terminal Curbside Expansion, New Energy Plant and Related Work Construction Admin

Project Fee Proposal - Hensel Phelps Team											
Main Terminal Curbside Expansion - HNTB Struct											
HCAA Project Number 8230-18											
3/13/2019											
Scope/Task		Sr. Struct	Proj Struct	Struct E.	Sr. Tech	Tech.	Admin	abc	def	ghi	Total
		Hours	Hours	Hours	Hours	Hours	Hours	Hours	Hours	Hours	Hours
Basic Design Services											
Task - CA Services HNTB											
1	Added CA Site Time				35						35.00
2											0.00
3											0.00
4											0.00
5											0.00
6											0.00
7											0.00
8											0.00
9											0.00
10											0.00
11											0.00
	Subtotal Hours	0.00	0.00	0.00	35.00	0.00	0.00	0.00	0.00	0.00	35.00
	Rate	\$ 85.31	\$ 52.50	\$ 38.85	\$ 40.95	\$ 29.40	\$ 21.00				
	Subtotal Direct Labor	\$ -	\$ -	\$ -	\$ 1,433.25	\$ -	\$ -	\$ -	\$ -	\$ -	\$ 1,433.25
	Subtotal Burdened Labor @		2.84								\$ 4,070.43

8230 18 MTCE Project
Tampa International Airport

CE 004

TLC Engineering

New HVAC air conditioning system, air handling equipment, and
ductwork and chilled and hot water piping

8230 18 MTCE Project
Tampa International Airport

CE 004

Henderson Consulting

Life safety consulting to analyze fire separation and code report to
obtain code approval from City of Tampa

Construction Administration Fee

Project Fee Proposal - Hensel Phelps Team											
Main Terminal Curbside Expansion - Henderson Consulting											
HCAA Project Number 8230-18											
3/13/2019											
Scope/Task		Principal	Director	Sr Code Cons	Code Cons	BIM/CADD	Admin	-	-	-	Total
		Hours	Hours	Hours	Hours	Hours	Hours	Hours	Hours	Hours	
Basic Design Services											
Task - CA Services HNTB											
1											0.00
2											0.00
3											0.00
4											0.00
5											0.00
6											0.00
7											0.00
8											0.00
9											0.00
10											0.00
11											0.00
Subtotal Hours		0.00	0.00	0.00	0.00	0.00	0.00	0.00	0.00	0.00	0.00
Rate		\$ 72.16	\$ 60.90	\$ 60.10	\$ 34.00	\$ 18.50	\$ 20.00	\$ -	\$ -	\$ -	
Subtotal Direct Labor		\$ -	\$ -	\$ -	\$ -	\$ -	\$ -	\$ -	\$ -	\$ -	\$ -
Subtotal Burdened Labor @			2.90								\$ -

8230 18 MTCE Project
Tampa International Airport

CE 004

Voltair Electrical

Electrical design for all new added elements for enclosed bridge



HENSEL PHELPS

Plan. Build. Manage.

6557 Hazeltine National Drive
Suite One
Orlando, FL 32822
407.856.2400

May 21, 2019

Hillsborough County Aviation Authority
Attn: Brian Rumble
Program Manager
Tampa International Airport

Subject: Request for Change Order CE#0008 – Owner Directive – Design of Airside D
Terminal Platform
8230 18 – MTCE Project
Tampa International Airport

Dear Brian:

Hensel Phelps Construction Co. is hereby submitting Change Estimate #0008 & #0008.1. Included are costs to design the future Airside D APM Station in conjunction with the Red Side VCB as part of the MTCE Project as directed by the Owner. The scope will include the structural frame, architectural shell and core MEP & IT building systems for a new APM terminal platform. This does not include costs for the design of the future baggage system for Airside D as that will be captured in a separate Change Estimate.

The total costs are separated into Design to 30% and 100% Construction Documents. The values are as follows:

CE #0008	30% Design Development	\$ 475,765.15
CE #0008.1	100% Construction Documents	<u>\$1,340,330.71</u>
	Airside D Core & Shell Total	\$1,816,095.86

The appropriate documentation associated with these values has been incorporated into this proposal.

Please do not hesitate to contact the project team with any questions or concerns.

Sincerely,
HENSEL PHELPS CONSTRUCTION CO.

Drew Krizman

Drew Krizman
Project Manager

c: 8016169, DK, SG

CE: 0008**Change Estimate Summary****HENSEL PHELPS**
Plan. Build. Manage.8230 18 - MTCE Project
Tampa International Airport

Company	Description of Scope	Change Estimate Totals		
		30%	60% - 100%	Total
HNTB Architectural	Architectural Building Design	\$ 134,257.24	\$ 653,445.36	\$ 787,702.60
HNTB Structural	Structural Building Design	\$ 74,558.52	\$ 109,240.60	\$ 183,799.12
HNTB Civil	Civil Design	\$ 65,198.49	\$ 178,702.96	\$ 243,901.45
Arehna	Geotech	\$ 7,878.66	\$ -	\$ 7,878.66
Echo	SUE Survey	\$ 19,207.18	\$ -	\$ 19,207.18
MCE	Structural Design	\$ 12,842.40	\$ 34,252.20	\$ 47,094.60
Ayres	SUE Survey	\$ 9,050.52	\$ 18,326.88	\$ 27,377.40
TLC	Mechanical, Plumbing & IT Design	\$ 11,820.45	\$ 37,928.33	\$ 49,748.78
Voltair	Electrical Design	\$ 33,999.66	\$ 80,405.61	\$ 114,405.27
Lea & Elliott	APM System Planning	\$ 106,952.03	\$ 149,320.30	\$ 256,272.33
Hensel Phelps	General Contractor	\$ -	\$ 78,708.47	\$ 78,708.47
		\$ -	\$ -	\$ -
		\$ -	\$ -	\$ -
SUBTOTAL:		\$ 475,765.15	\$ 1,340,330.71	\$ 1,816,095.86

INITIATING DOCUMENTS

Owner Directive

The Owner has decided to include the design of the future Airside D APM Station into the MTCE Project. This is to be treated as a direct extension of the Red Side VCB Project and will be designed, bid and built in concert with the Red Side Project. The cost within includes the structural frame, architectural shell and core MEP& IT building systems for a new Airport People Mover (APM) station for the future Airside D.

Tampa international Airport
CE08 Airside D APM Station Shell and Core

Scope of work

HCAA has decided to include the design of the Airside D APM Station into the MTCE project. The following is the scope for that design.

This project would be treated as a direct extension of the Red Side Vertical Circulation Building project (8230-18-RSC) and will be designed, bid and built at the same time with the Red Side project package. It is essential that the **Red Side design**, the **Airside D APM Station design** and the **Airside D Baggage System design** are being designed simultaneously together as they all will work as one building in the end and must be closely coordinated. One task cannot be designed without the others.

This project includes the structural frame, architectural shell and core MEP and IT building systems for a new APM Station for the future Airside D. The design of the shell space for the station will closely match the existing stations in the main terminal. The exterior shell of the station will be completely designed. It will be a complete weather proofed enclosure with exterior walls and roof with a temporary exterior wall(s) where the future APM trains will enter the station. The exterior metal panel and glazed walls will be complete with watertight construction and insulation where applicable. The departure level roadway will be covered by the structural floor of the APM station and in addition an extended canopy will be designed to the similar extent of the road canopy on the blue side. A complete soffit/ceiling system with lighting and signage will be designed for the west end of red side departure level canopy. The canopy/APM station floor will include a right of way for the future Airside D baggage system. The canopy ceiling will match the materials on the blue side but will have a different configuration due to the APM station above. Special structural and architectural modifications will be necessary to weave the Airside D Baggage system right-of-way, under or adjacent to, the APM station floor to line up with the future guideway.

The interior space of the entire station areas will be an unfinished shell consisting of exposed steel studded exterior walls with exposed insulation or glazing with no interior finish materials. There will be temporary interior gypsum board walls separating the unfinished station from the main terminal. No gypsum wallboard will be on the interior of the station walls to allow for future electrical and other services to be installed inside the walls by others. The floor will have an exposed concrete floor with no finish. There will be no ceilings and the fireproofed structure will be exposed.

A new exit stair being built in the current "project to demolish the red car garage" will be relocated elsewhere in the Red side project and the existing stair demolished in this scope. The old remaining piece of the Airside D original guideway will be demolished and the exit opening from the main terminal closed by metal panels.

All minimum code required MEP systems will be installed including fire protection, and other systems to obtain a building permit and certificate of occupancy of the red side construction. An HVAC air handling room and air handling equipment will be designed for the space. Ductwork will be stubbed into the

station space, but no distribution ductwork will be designed for the station space. Chilled and hot water will be piped to the air handler and stubbed into the station space, but no distribution throughout the station space. Code minimum lighting to obtain a building permit and obtain a certificate of occupancy will be placed in the station space but no general lighting will be provided. Power conduits will be stubbed into the space.

Current HCAA offices north of the Yeager elevator bank but outside of the future station space will be demolished in this scope and reconfigured into main terminal public space. This space will be fully outfitted with new flooring, ceilings, lighting, air distribution, public announcement speakers, and life safety sprinklers and systems.

30% design discipline scopes:

1. **Surveying** – Supplemental surveying will be required to establish any underground utilities and topography near the future APM station and guideway route and future foundations and shifts of the service road.
2. **Geotech** - Added Geotech borings and foundation consulting will be necessary for combined APM/building columns, new APM columns and some added pavement for modifications to the service road and at grade pavement.
3. **APM system planning** (Lea + Elliott)- Planning and preliminary design from Lea+ Elliot to provide the following:
 - Dimensions of rails systems, APM train cars, train wells, heights and all other required dimensional information to accommodate future APM trains.
 - All structural loading criteria for APM trains including dead load, live load and dynamic loading.
 - All electrical requirements for the APM trains at the station and what switchgear would be reserved for these future loads
 - All load requirements for mechanical, HVAC, fire protection required for the APM system and station
 - All IT stub outs to the station space required for APM and station
 - All specialized fire alarms (if required) for APM system.
4. **Structural engineering.** All Building and elevated roadway superstructure impacted due to the APM station including, concrete decks and curtainwall supports and miscellaneous structure. Structural design shall be taken to a point in the design where all design calculations are complete and structural modelling is complete to ensure the structural components will work without any unknowns and will work in unison with the red side roadway and red side vertical circulation building.
5. **Civil engineering.** The service roadway will have to be modified to accommodate the new APM station structures and alignment. Adjacent pavement and site areas will have to be modified as well.
6. **Fire life safety Analysis-** A existing and life safety analysis will be analyzed to confirm proper egress, and other fire life safety issues will be required including potential replacement and elimination of the temporary exit installed as a part of the old red side Airside D guideway.
7. **Exterior Architecture.** The exterior architecture shell including exterior walls, floor, roof and soffits/ceiling of departure level roadway canopy.

8. **Architectural interior** includes interface points of where the MTCE project meets the station will be designed, but NOT the interior of the station itself. The station will have no interior finishes or ceilings. There will be no design for the glass/door automatic APM doors or the enclosure known as the “train tubes”. Only structural connection points for future “train tubes” will be accommodated.
9. **HVAC/Mechanical** - Includes the air handling unit and system and room that will serve the future APM station interior, but the distribution of supply and return ducts will only be brought to the perimeter of the space, not within the APM station interior space.
10. **Plumbing.** Plumbing drains and potable water stubbed into the space. Design of roof and west end departures level roadway canopy drains and routes to storm system will be designed.
11. **Fire protection-** Design of the fire protection system to get a permit for the entire MTCE and unfinished APM station. The fire protection system will have to be modified by the future fit out of the interior APM station by others for the final ceiling configuration.
12. **Electrical-** Design of code required minimal lighting within interior unfinished APM space to get permit. Power conduit stubbed into space. Design of Fire alarm/strobes to meet code within the space. Minimal Voice evacuation annunciation system to obtain building permit. These systems may have to be modified by others for the final APM system interior configuration. No rail, electrical or train signal systems for the APM trains will be provided. An architectural lighting study will be conducted on the west end of the red side canopy above departure roadway.
13. **Fire Alarm** – Design of code required fire alarm system in unfinished APM space to get a permit.
14. **IT low voltage Design-** Fiber backbone conduit stubbed into space. Any exit doors or other secure doors will be provided with access control and CCTV as required to maintain airport security standards for the shell space.
15. **Egress analysis.** Egress analysis will be performed to accommodate the required exits needed for the Red side. It is assumed that future added exits on to the future Airside D guideway will be accommodated by others in the interior fit out by others of the APM station at the main terminal.
16. **Signage** – No signage will be included in 30% Design for APM station area. In 60%, 90% and 100% submittals and drawings for areas outside the station shell that may be impacted will have any signage design modifications to existing signs or new signs.
17. **Meetings** specific to the APM design
18. **QA/QC** specific to the APM station design
19. **Renderings and Power points** specific to the APM station shell

The 60% design will involve the same disciplines as the 30% design but taken to a 60% level of design evolution with greater detail. 30% Owner comments will be incorporated.

Similarly, for 90% design this will involve the same disciplines as the 30% and 60% design but taken to a 90% level of design evolution and into construction documents. The 90% design drawings would be submitted to the City of Tampa for permit review. 60% Owner comments will be incorporated.

100% construction documents would be incorporate all City of Tampa comments and all HCAA 90% comments. Upon completion of all review comments and any clarifications to bidders an “issued for construction” set would be generated.

SUBCONTRACTOR PRICING

1	HNTB Architectural
2	HNTB Structural
3	HNTB Civil
4	Arehna
5	Echo
6	MCE
7	Ayres
8	TLC
9	Voltair
10	Lea & Elliott
11	Hensel Phelps

8230 18 MTCE Project
Tampa International Airport

CE 0008

HNTB Architectural

Architectural Building Design

Main Terminal Curbside Expansion, New Energy Plant and Related Work

HCAA Project Numbers 8230-18-BCS, 8230-18-RCS, 8200-18, 8205-18-CEP, 8205-18-LDB, 8900-18, 8240-19

3/29/2019

Basic Design Services		30%	60%	90%	100%	Total	Construction	Total	W/MBE %	% W/MBE	% Construction
Engineering & Preconstruction Services		Design Dev.	Design Dev.	Const. Docs	Final Docs	Part 1	Administration		of Fee	Goal	Cost
PCO-0008	Main Terminal Curbside Expansion - HNTB Arch	\$ 128,257.24	\$ 248,551.12	\$ 258,377.52	\$ 128,816.72	\$ 764,002.60	\$ 96,951.92	\$ 860,954.52			
PCO-0008	Main Terminal Curbside Expansion - HNTB Struct	\$ 74,558.52	\$ 42,103.00	\$ 48,007.36	\$ 19,130.24	\$ 183,799.12	\$ 76,112.00	\$ 259,911.12			
PCO-0008	Main Terminal Curbside Expansion - HNTB Civil	\$ 63,361.02	\$ 72,257.92	\$ 64,112.01	\$ 37,296.70	\$ 237,027.65	\$ 15,250.06	\$ 252,277.71			
PCO-0008	Main Terminal Curbside Expansion - Arehna	\$ 7,878.66	\$ -	\$ -	\$ -	\$ 7,878.66	\$ -	\$ 7,878.66			
PCO-0008	Main Terminal Curbside Expansion - ECHO	\$ 19,207.18	\$ -	\$ -	\$ -	\$ 19,207.18	\$ -	\$ 19,207.18			
PCO-0008	Main Terminal Curbside Expansion - MCE	\$ 12,842.40	\$ 12,842.40	\$ 12,842.40	\$ 8,567.40	\$ 47,094.60	\$ 24,340.50	\$ 71,435.10			
PCO-0008	Main Terminal Curbside Expansion - Ayres	\$ 9,050.52	\$ 11,489.40	\$ 6,837.48	\$ -	\$ 27,377.40	\$ -	\$ 27,377.40			
PCO-0008	Main Terminal Curbside Expansion - Henderson (Acoustics)	\$ -	\$ -	\$ -	\$ -	\$ -	\$ -	\$ -			
PCO-0008	Main Terminal Curbside Expansion - Henderson (Arch Lighting)	\$ -	\$ -	\$ -	\$ -	\$ -	\$ -	\$ -			
PCO-0008	Main Terminal Curbside Expansion - Henderson (Code Consulting)	\$ -	\$ -	\$ -	\$ -	\$ -	\$ -	\$ -			
PCO-0008	Main Terminal Curbside Expansion - TLC	\$ 11,820.45	\$ 14,044.59	\$ 14,832.50	\$ 9,051.23	\$ 49,748.78	\$ 9,047.80	\$ 58,796.58			
PCO-0008	Main Terminal Curbside Expansion - LA Design	\$ -	\$ -	\$ -	\$ -	\$ -	\$ -	\$ -			
PCO-0008	Main Terminal Curbside Expansion - Voltair	\$ 33,999.66	\$ 33,999.66	\$ 33,999.66	\$ 12,406.29	\$ 114,405.27	\$ 30,337.05	\$ 144,742.31			
PCO-0008	Main Terminal Curbside Expansion - Lea & Elliott	\$ 106,952.03	\$ 49,773.43	\$ 49,773.43	\$ 49,773.43	\$ 256,272.33	\$ -	\$ 256,272.33			
Design Phase Sub Total		\$ 467,927.69	\$ 485,061.52	\$ 488,782.36	\$ 265,042.02	\$ 1,706,813.59	\$ 252,039.33	\$ 1,958,852.92			
Reimbursable Expenses											
PCO-0008	Main Terminal Curbside Expansion - HNTB Arch	\$ 6,000.00	\$ 9,000.00	\$ 6,000.00	\$ 2,700.00	\$ 23,700.00	\$ 2,700.00	\$ 26,400.00			
PCO-0008	Main Terminal Curbside Expansion - HNTB Struct	\$ -	\$ -	\$ -	\$ -	\$ -	\$ -	\$ -			
PCO-0008	Main Terminal Curbside Expansion - HNTB Civil	\$ 1,837.47	\$ 2,095.48	\$ 1,859.25	\$ 1,081.60	\$ 6,873.80	\$ 1,220.00	\$ 8,093.80			
PCO-0008	Main Terminal Curbside Expansion - Arehna	\$ -	\$ -	\$ -	\$ -	\$ -	\$ -	\$ -			
PCO-0008	Main Terminal Curbside Expansion - ECHO	\$ -	\$ -	\$ -	\$ -	\$ -	\$ -	\$ -			
PCO-0008	Main Terminal Curbside Expansion - MCE	\$ -	\$ -	\$ -	\$ -	\$ -	\$ -	\$ -			
PCO-0008	Main Terminal Curbside Expansion - Ayres	\$ -	\$ -	\$ -	\$ -	\$ -	\$ -	\$ -			
PCO-0008	Main Terminal Curbside Expansion - Henderson (Acoustics)	\$ -	\$ -	\$ -	\$ -	\$ -	\$ -	\$ -			
PCO-0008	Main Terminal Curbside Expansion - Henderson (Arch Lighting)	\$ -	\$ -	\$ -	\$ -	\$ -	\$ -	\$ -			
PCO-0008	Main Terminal Curbside Expansion - Henderson (Code Consulting)	\$ -	\$ -	\$ -	\$ -	\$ -	\$ -	\$ -			
PCO-0008	Main Terminal Curbside Expansion - TLC	\$ -	\$ -	\$ -	\$ -	\$ -	\$ -	\$ -			
PCO-0008	Main Terminal Curbside Expansion - LA Design	\$ -	\$ -	\$ -	\$ -	\$ -	\$ -	\$ -			
PCO-0008	Main Terminal Curbside Expansion - Voltair	\$ -	\$ -	\$ -	\$ -	\$ -	\$ -	\$ -			
PCO-0008	Main Terminal Curbside Expansion - Lea & Elliott	\$ -	\$ -	\$ -	\$ -	\$ -	\$ -	\$ -			
Reimbursables Sub Total		\$ 7,837.47	\$ 11,095.48	\$ 7,859.25	\$ 3,781.60	\$ 30,573.80	\$ 3,920.00	\$ 34,493.80			
Total Fee, Allowances, Reimbursable Expenses		\$ 475,765.16	\$ 496,157.00	\$ 496,641.61	\$ 268,823.62	\$ 1,737,387.39	\$ 255,959.33	\$ 1,993,346.72			

100% Design Fee

Main Terminal Curbside Expansion, New Energy Plant and Related Work 100% Design

Project Fee Proposal - Hensel Phelps Team																
Main Terminal Curbside Expansion - HNTB Arch																
HCAA Project Number 8230-18																
3/29/2019																
Scope/Task			Project Dir	Chief Arch	Sr PM	SR PA	Proj Arch	Arch/Des	P Analyst	Admin						Total
Basic Design Services			Hours	Hours	Hours	Hours	Hours	Hours	Hours	Hours	Hours	Hours	Hours	Hours	Hours	Hours
Task - 100% Design																
1 Design Management					17.00				3.00							20.00
2 Design Studies				17.00												17.00
3 Documentation/BIM				28.00		169.00	34.00	443.00		17.00						691.00
4 Consultant Coordination				28.00		68.00		79.00								175.00
5 QA/QC				8.00		51.00										59.00
6																0.00
7																0.00
8																0.00
9																0.00
10																0.00
11																0.00
Subtotal Hours			0.00	81.00	17.00	288.00	34.00	522.00	3.00	17.00	0.00	0.00	0.00	0.00	0.00	962.00
Rate			\$ 139.08	\$ 114.00	\$ 69.00	\$ 59.00	\$ 46.00	\$ 30.00	\$ 41.00	\$ 36.00						
Subtotal Direct Labor			\$ -	\$ 9,234.00	\$ 1,173.00	\$ 16,992.00	\$ 1,564.00	\$ 15,660.00	\$ 123.00	\$ 612.00	\$ -	\$ -	\$ -	\$ -	\$ -	\$ 45,358.00
Subtotal Burdened Labor @				2.84												\$ 128,816.72

8230 18 MTCE Project
Tampa International Airport

CE 0008

HNTB Structural

Structural Building Design

60% Design Fee

Project Fee Proposal - Hensel Phelps Team															
Main Terminal Curbside Expansion - HNTB Struct															
HCAA Project Number 8230-18															
3/29/2019															
Scope/Task		Struct PM	Sr. Struct QC	Sr. Struct	Struct E.	Sr. Tech	Tech								Total
		Hours	Hours	Hours	Hours	Hours	Hours	Hours	Hours	Hours	Hours	Hours	Hours	Hours	
Basic Design Services															
Task - 60% Design															
1	Concept design														0.00
2	Platform Structural analysis			54.00	102.00										156.00
3	Modeling						96.00								96.00
4	Meetings	8.00		24.00											32.00
5	QC	4	28	2											34.00
6															0.00
7															0.00
8															0.00
9															0.00
10															0.00
11															0.00
Subtotal Hours		12.00	28.00	80.00	102.00	0.00	96.00	0.00	0.00	0.00	0.00	0.00	0.00	0.00	318.00
Rate		\$ 83.50	\$ 71.50	\$ 62.00	\$ 39.50	\$ 39.00	\$ 29.50								
Subtotal Direct Labor		\$ 1,002.00	\$ 2,002.00	\$ 4,960.00	\$ 4,029.00	\$ -	\$ 2,832.00	\$ -	\$ -	\$ -	\$ -	\$ -	\$ -	\$ -	\$ 14,825.00
Subtotal Burdened Labor @			2.84												\$ 42,103.00

90% Design Fee

Project Fee Proposal - Hensel Phelps Team															
Main Terminal Curbside Expansion - HNTB Struct															
HCAA Project Number 8230-18															
3/29/2019															
Scope/Task		Struct PM	Sr. Struct QC	Sr. Struct	Struct E.	Sr. Tech	Tech								Total
		Hours	Hours	Hours	Hours	Hours	Hours	Hours	Hours	Hours	Hours	Hours	Hours	Hours	
Basic Design Services															
Task - 90% Design															
1	Concept design														0.00
2	Platform Structural analysis			60.00	118.00										178.00
3	Modeling						118.00								118.00
4	Meetings	5.00		16.00											21.00
5	QC	2.00	45.00	4.00											51.00
6															0.00
7															0.00
8															0.00
9															0.00
10															0.00
11															0.00
Subtotal Hours		7.00	45.00	80.00	118.00	0.00	118.00	0.00	0.00	0.00	0.00	0.00	0.00	0.00	368.00
Rate		\$ 83.50	\$ 71.50	\$ 62.00	\$ 39.50	\$ 39.00	\$ 29.50								
Subtotal Direct Labor		\$ 584.50	\$ 3,217.50	\$ 4,960.00	\$ 4,661.00	\$ -	\$ 3,481.00	\$ -	\$ -	\$ -	\$ -	\$ -	\$ -	\$ -	\$ 16,904.00
Subtotal Burdened Labor @			2.84												\$ 48,007.36

100% Design Fee

Project Fee Proposal - Hensel Phelps Team															
Main Terminal Curbside Expansion - HNTB Struct															
HCAA Project Number 8230-18															
3/29/2019															
Scope/Task		Struct PM	Sr. Struct QC	Sr. Struct	Struct E.	Sr. Tech	Tech								Total
		Hours	Hours	Hours	Hours	Hours	Hours	Hours	Hours	Hours	Hours	Hours	Hours	Hours	
Basic Design Services															
Task - 100% Design															
1	Concept design														0.00
2	Platform Structural analysis			28.00	48.00										76.00
3	Modeling						48.00								48.00
4	Meetings	2.00		4.00											6.00
5	QC	2.00	12.00	4.00											18.00
6															0.00
7															0.00
8															0.00
9															0.00
10															0.00
11															0.00
Subtotal Hours		4.00	12.00	36.00	48.00	0.00	48.00	0.00	0.00	0.00	0.00	0.00	0.00	0.00	148.00
Rate		\$ 83.50	\$ 71.50	\$ 62.00	\$ 39.50	\$ 39.00	\$ 29.50								
Subtotal Direct Labor		\$ 334.00	\$ 858.00	\$ 2,232.00	\$ 1,896.00	\$ -	\$ 1,416.00	\$ -	\$ -	\$ -	\$ -	\$ -	\$ -	\$ -	\$ 6,736.00
Subtotal Burdened Labor @			2.84												\$ 19,130.24

8230 18 MTCE Project
Tampa International Airport

CE 0008

HNTB Civil

Civil Design

30% Design Fee

Project Fee Proposal - Hensel Phelps Team															
Main Terminal Curbside Expansion - HNTB Civil															
HCAA Project Number 8230-18															
3/29/2019															
Scope/Task		PM	PD	Chief Eng/Planner	Sr. PE	PE	Eng.	Sr. Des.	Des.	Sr. Tech	Clerical	PA	Specialist	Specialist	Total
Basic Design Services		Hours	Hours	Hours	Hours	Hours	Hours	Hours	Hours	Hours	Hours	Hours	Hours	Hours	Hours
Task - 30% Design															
1	Project Management	14.00	0.00	0.00	0.00	0.00	0.00	0.00	0.00	0.00	6.00	4.00	0.00		24.00
2	Grading/Roadway Design	2.00	0.00	4.00	10.00	13.00	14.00	7.00	9.00	5.00	1.00	0.00	0.00		65.00
3	Roadway Plans	1.00	0.00	2.00	5.00	7.00	7.00	4.00	5.00	3.00	1.00	0.00	0.00		35.00
4	Drainage Design	3.00	0.00	4.00	16.00	18.00	21.00	9.00	14.00	7.00	2.00	0.00	0.00		94.00
5	Signing and Pavement Marking	1.00	0.00	2.00	6.00	8.00	8.00	4.00	6.00	4.00	1.00	0.00	0.00		40.00
6	Lighting Design	1.00	0.00	2.00	4.00	4.00	6.00	2.00	4.00	2.00	0.00	0.00	0.00		25.00
7	Environmental Permits	1.00	0.00	2.00	2.00	2.00	0.00	0.00	2.00	0.00	0.00	0.00	0.00		9.00
8	Bridge Structural Engineering	0.00	0.00	4.00	12.00	36.00	30.00	0.00	12.00	22.00	0.00	0.00	0.00		116.00
9															0.00
10															0.00
11															0.00
Subtotal Hours		23.00	0.00	20.00	55.00	88.00	86.00	26.00	52.00	43.00	11.00	4.00		0.00	408.00
	Rate	\$ 123.85	\$ 139.08	\$ 91.82	\$ 70.16	\$ 53.40	\$ 44.27	\$ 53.72	\$ 43.26	\$ 27.71	\$ 24.80	\$ 37.37	\$ 97.23	\$ 97.23	
	Subtotal Direct Labor	\$ 2,848.55	\$ -	\$ 1,836.40	\$ 3,858.80	\$ 4,699.20	\$ 3,807.22	\$ 1,396.72	\$ 2,249.52	\$ 1,191.53	\$ 272.80	\$ 149.48	\$ -	\$ -	\$ 22,310.22
	Subtotal Burdened Labor @		2.84												\$ 63,361.02

8230 18 MTCE Project
Tampa International Airport

CE 0008

Arehna

Geotech

30% Design Fee

Project Fee Proposal - Hensel Phelps Team															
Main Terminal Curbside Expansion - Arehna															
HCAA Project Number 8230-18															
3/29/2019															
Scope/Task		Project Manager	Principal Engineer	Senior Engineer	Geotechnical Engineer	Engineer Intern	Senior Designer	Senior Engineering Technician	Secretary Clerical	Engineering Technician				-	Total
		Hours	Hours	Hours	Hours	Hours	Hours	Hours	Hours	Hours	Hours	Hours		Hours	
Basic Design Services															
Task - 30% Design															
1	Geotechnical	8.00	1.00	20.00	6.00	18.00	8.00		1.00						62.00
2															0.00
3															0.00
4															0.00
5															0.00
6															0.00
7															0.00
8															0.00
9															0.00
10															0.00
11															0.00
	Subtotal Hours	8.00	1.00	20.00	6.00	18.00	8.00	0.00	1.00	0.00	0.00	0.00		0.00	62.00
	Rate	\$ 60.10	\$ 64.90	\$ 56.97	\$ 36.06	\$ 25.96	\$ 29.81	\$ 25.00	\$ 19.00	\$ 16.00	\$ -	\$ -		\$ -	
	Subtotal Direct Labor	\$ 480.80	\$ 64.90	\$ 1,139.40	\$ 216.36	\$ 467.28	\$ 238.48	\$ -	\$ 19.00	\$ -	\$ -	\$ -		\$ -	\$ 2,626.22
	Subtotal Burdened Labor @		3.00												\$ 7,878.66

8230 18 MTCE Project
Tampa International Airport

CE 0008

Echo

SUE Survey

8230 18 MTCE Project
Tampa International Airport

CE 0008

MCE

Structural Design

30% Design Fee

Project Fee Proposal - Hensel Phelps Team															
Main Terminal Curbside Expansion - MCE															
HCAA Project Number 8230-18															
3/29/2019															
Scope/Task		Principal	PM	Sr. AE	AE	Sr. Design	Admin							-	Total
		Hours	Hours	Hours	Hours	Hours	Hours	Hours	Hours	Hours	Hours	Hours	Hours	Hours	
Basic Design Services															
Task - 30% Design															
1	Meetings and Coordination	16.00	16.00												32.00
2	Structural System Determination	16.00	40.00												56.00
3	30% Design Production														0.00
4	Prepare Deliverable Documents														0.00
5	QA / QC														0.00
6	Admin														0.00
7															0.00
8															0.00
9															0.00
10															0.00
11															0.00
Subtotal Hours		32.00	56.00	0.00	0.00	0.00	0.00	0.00	0.00	0.00	0.00	0.00	0.00	0.00	88.00
Rate		\$ 70.67	\$ 36.06	\$ -	\$ 30.05	\$ 27.30	\$ 25.50	\$ -	\$ -	\$ -	\$ -	\$ -	\$ -	\$ -	\$ -
Subtotal Direct Labor		\$ 2,261.44	\$ 2,019.36	\$ -	\$ -	\$ -	\$ -	\$ -	\$ -	\$ -	\$ -	\$ -	\$ -	\$ -	\$ 4,280.80
Subtotal Burdened Labor @			3.00												\$ 12,842.40

90% Design Fee

Project Fee Proposal - Hensel Phelps Team															
Main Terminal Curbside Expansion - MCE															
HCAA Project Number 8230-18															
3/29/2019															
Scope/Task		Principal	PM	Sr. AE	AE	Sr. Design	Admin							-	Total
		Hours	Hours	Hours	Hours	Hours	Hours	Hours	Hours	Hours	Hours	Hours	Hours	Hours	Hours
Basic Design Services															
Task - 90% Design															
1	Meetings and Coordination	16	16												32.00
2	Structural Framing	16	40												56.00
3	90% Design Production														0.00
4	Specifications														0.00
5	Prepare Deliverable Documents														0.00
6	QA / QC														0.00
7	Admin														0.00
8															0.00
9															0.00
10															0.00
11															0.00
Subtotal Hours		32.00	56.00	0.00	0.00	0.00	0.00	0.00	0.00	0.00	0.00	0.00	0.00	0.00	88.00
Rate		\$ 70.67	\$ 36.06	\$ -	\$ 30.05	\$ 27.30	\$ 25.50	\$ -	\$ -	\$ -	\$ -	\$ -	\$ -	\$ -	
Subtotal Direct Labor		\$ 2,261.44	\$ 2,019.36	\$ -	\$ -	\$ -	\$ -	\$ -	\$ -	\$ -	\$ -	\$ -	\$ -	\$ -	\$ 4,280.80
Subtotal Burdened Labor @			3.00												\$ 12,842.40

100% Design Fee

Project Fee Proposal - Hensel Phelps Team															
Main Terminal Curbside Expansion - MCE															
HCAA Project Number 8230-18															
3/29/2019															
Scope/Task		Principal	PM	Sr. AE	AE	Sr. Design	Admin							-	Total
		Hours	Hours	Hours	Hours	Hours	Hours	Hours	Hours	Hours	Hours	Hours	Hours	Hours	
Basic Design Services															
Task - 100% Design															
1	Meetings and Coordination	8	8												16.00
2	Structural Framing	12	32												44.00
3	90% Design Production														0.00
4	Specifications														0.00
5	Prepare Deliverable Documents														0.00
6	QA / QC														0.00
7	Admin														0.00
8															0.00
9															0.00
10															0.00
11															0.00
Subtotal Hours		20.00	40.00	0.00	0.00	0.00	0.00	0.00	0.00	0.00	0.00	0.00	0.00	0.00	60.00
Rate		\$ 70.67	\$ 36.06	\$ -	\$ 30.05	\$ 27.30	\$ 25.50	\$ -	\$ -	\$ -	\$ -	\$ -	\$ -	\$ -	
Subtotal Direct Labor		\$ 1,413.40	\$ 1,442.40	\$ -	\$ -	\$ -	\$ -	\$ -	\$ -	\$ -	\$ -	\$ -	\$ -	\$ -	\$ 2,855.80
Subtotal Burdened Labor @			3.00												\$ 8,567.40

8230 18 MTCE Project
Tampa International Airport

CE 0008

Ayres

SUE Survey

30% Design Fee

Project Fee Proposal - Hensel Phelps Team															
Main Terminal Curbside Expansion - Ayres															
HCAA Project Number 8240-19															
3/29/2019															
Scope/Task		Ayres CM	Project Manager	Sr. Util. Coord.	Sr. Project Engineer	Sr. Design	Project Engineer	SUE crew	Des Crew	OT Crew				-	Total
Basic Design Services		Hours	Hours	Hours	Hours	Hours	Hours	Hours	Hours	Hours	Hours	Hours	Hours	Hours	Hours
Task - 30% Design															
1	Geotechnical														0.00
2	Project Management -Ayres	10.00													10.00
3	Records Research					10.00									10.00
4	Utility Coordination			50.00											50.00
5	QAQC	3.00													3.00
6															0.00
7															0.00
8															0.00
9															0.00
10															0.00
11															0.00
Subtotal Hours		13.00	0.00	50.00	0.00	10.00	0.00	0.00	0.00	0.00	0.00	0.00	0.00	0.00	73.00
	Rate	\$ 63.48	\$ 52.10	\$ 36.86	\$ 35.43	\$ 34.86	\$ 31.25	\$ 237.50	\$ 200.00	\$ 356.25	\$ -	\$ -	\$ -	\$ -	
	Subtotal Direct Labor	\$ 825.24	\$ -	\$ 1,843.00	\$ -	\$ 348.60	\$ -	\$ -	\$ -	\$ -	\$ -	\$ -	\$ -	\$ -	\$ 3,016.84
	Subtotal Burdened Labor @		3.00												\$ 9,050.52

60% Design Fee

Project Fee Proposal - Hensel Phelps Team															
Main Terminal Curbside Expansion - Ayres															
HCAA Project Number 8240-19															
3/29/2019															
Scope/Task		Ayres CM	Project Manager	Sr. Util. Coord	Project Engin	Sr. Design	Project Engineer	SUE crew	Des Crew	OT Crew				-	Total
		Hours	Hours	Hours	Hours	Hours	Hours	Hours	Hours	Hours	Hours	Hours	Hours	Hours	Hours
Basic Design Services															
Task - 60% Design															
1	Geotechnical														0.00
2	Project Management - Ayres	15													15.00
3	Records Research					5									5.00
4	Utility Coordination			60.00		5.00									65.00
5	QAQC	5.00													5.00
6															0.00
7															0.00
8															0.00
9															0.00
10															0.00
11															0.00
Subtotal Hours		20.00	0.00	60.00	0.00	10.00	0.00	0.00	0.00	0.00	0.00	0.00	0.00	0.00	90.00
Rate		\$ 63.48	\$ 52.10	\$ 36.86	\$ 35.43	\$ 34.86	\$ 31.25	\$ 237.50	\$ 200.00	\$ 356.25	\$ -	\$ -	\$ -	\$ -	
Subtotal Direct Labor		\$ 1,269.60	\$ -	\$ 2,211.60	\$ -	\$ 348.60	\$ -	\$ -	\$ -	\$ -	\$ -	\$ -	\$ -	\$ -	\$ 3,829.80
Subtotal Burdened Labor @			3.00												\$ 11,489.40

90% Design Fee

Project Fee Proposal - Hensel Phelps Team															
Main Terminal Curbside Expansion - Ayres															
HCAA Project Number 8240-19															
3/29/2019															
Scope/Task		Ayres CM	Project Manager	Sr. Util. Coord	Project Engin	Sr. Design	Project Engineer	SUE crew	Des Crew	OT Crew				-	Total
		Hours	Hours	Hours	Hours	Hours	Hours	Hours	Hours	Hours	Hours	Hours	Hours	Hours	Hours
Basic Design Services															
Task - 90% Design															
1	Geotechnical														0.00
2	Project Management -Ayres	10	0		0		0.00								10.00
3	Records Research														0.00
4	Utility Coordination			36											36.00
5	QAQC	5													5.00
6															0.00
7															0.00
8															0.00
9															0.00
10															0.00
11															0.00
Subtotal Hours		15.00	0.00	36.00	0.00	0.00	0.00	0.00	0.00	0.00	0.00	0.00	0.00	0.00	51.00
Rate		\$ 63.48	\$ 52.10	\$ 36.86	\$ 35.43	\$ 34.86	\$ 31.25	\$ 237.50	\$ 200.00	\$ 356.25	\$ -	\$ -	\$ -	\$ -	\$ -
Subtotal Direct Labor		\$ 952.20	\$ -	\$ 1,326.96	\$ -	\$ -	\$ -	\$ -	\$ -	\$ -	\$ -	\$ -	\$ -	\$ -	\$ 2,279.16
Subtotal Burdened Labor @			3.00												\$ 6,837.48

8230 18 MTCE Project
Tampa International Airport

CE 0008

TLC

Mechanical, Plumbing & IT Design

30% Design Fee

Project Fee Proposal - Hensel Phelps Team																											
Main Terminal Curbside Expansion - TLC																											
HCAA Project Number 8240-19																											
3/29/2019																											
Scope/Task		Principal	-	Sr. Engineer	Engineer II	Engineer I	Admin	Sr. Tech	Tech II	CAD Tech				-	Total												
		Hours	Hours	Hours	Hours	Hours	Hours	Hours	Hours	Hours	Hours	Hours	Hours	Hours	Hours												
Basic Design Services																											
Task - 30% Design																											
1	Evaluation/relocation existing infra.			4.00	8.00			4.00							16.00												
2	Weekly Design Meetings			4.00											4.00												
3	Weekly OAC Meetings			2.00											2.00												
4	Drawing Development							2.00	8.00	8.00					18.00												
5	Narrative/Spec Development			4.00	12.00		4.00	2.00							22.00												
6	Coordination				4.00			2.00							6.00												
7	Quality Control				2.00										2.00												
8	Response to Comments				1.00	1.00	1.00								3.00												
9	Project Management		4.00												4.00												
10	Calculations			4.00	8.00										12.00												
11															0.00												
	Subtotal Hours		4.00	0.00	21.00	33.00	0.00	5.00	10.00	8.00	8.00	0.00	0.00	0.00	89.00												
	Rate	\$	77.88	\$	56.07	\$	54.40	\$	42.09	\$	36.63	\$	25.72	\$	62.50	\$	32.69	\$	25.50	\$	-	\$	-	\$	-	\$	-
	Subtotal Direct Labor	\$	311.52	\$	-	\$	1,142.40	\$	1,388.97	\$	-	\$	128.60	\$	625.00	\$	261.52	\$	204.00	\$	-	\$	-	\$	-	\$	4,062.01
	Subtotal Burdened Labor @			2.91											\$	11,820.45											

60% Design Fee

Project Fee Proposal - Hensel Phelps Team															
Main Terminal Curbside Expansion - TLC															
HCAA Project Number 8240-19															
3/29/2019															
Scope/Task		Principal	-	Sr. Engineer	Engineer II	Engineer I	Admin	Sr. Tech	Tech II	CAD Tech				-	Total
		Hours	Hours	Hours	Hours	Hours	Hours	Hours	Hours	Hours	Hours	Hours	Hours	Hours	Hours
Basic Design Services															
Task - 60% Design															
1	Evaluation/relocation existing infra.							1.00	2.00	2.00					5.00
2	Weekly Design Meetings			8.00											8.00
3	Weekly OAC Meetings														0.00
4	Drawing Development				16.00	48.00		3.00	4.00	4.00					75.00
5	Narrative/Spec Development			4.00			4.00	1.00							9.00
6	Coordination				8.00				2.00						10.00
7	Quality Control			2.00											2.00
8	Response to Comments			1.00	1.00		1.00		1.00						4.00
9	Project Management	4.00													4.00
10															0.00
11															0.00
Subtotal Hours		4.00	0.00	15.00	25.00	48.00	5.00	5.00	9.00	6.00	0.00	0.00		0.00	117.00
Rate		\$ 77.88	\$ 56.07	\$ 54.40	\$ 42.09	\$ 36.63	\$ 25.72	\$ 62.50	\$ 32.69	\$ 25.50	\$ -	\$ -		\$ -	
Subtotal Direct Labor		\$ 311.52	\$ -	\$ 816.00	\$ 1,052.25	\$ 1,758.24	\$ 128.60	\$ 312.50	\$ 294.21	\$ 153.00	\$ -	\$ -		\$ -	\$ 4,826.32
Subtotal Burdened Labor @			2.91												\$ 14,044.59

100% Design Fee

Project Fee Proposal - Hensel Phelps Team															
Main Terminal Curbside Expansion - TLC															
HCAA Project Number 8240-19															
3/29/2019															
Scope/Task	Principal	-	Sr. Engineer	Engineer II	Engineer I	Admin	Sr. Tech	Tech II	CAD Tech	Hours	Hours	-	Hours	Total	
Basic Design Services															
Task - 100% Design															
1	Evaluation/relocation existing infra.														0.00
2	Weekly Design Meetings			4.00				2.00							6.00
3	Weekly OAC Meetings														0.00
4	Drawing Development				8.00	32.00									40.00
5	Narrative/Spec Development			4.00			4.00	1.00	2.00	2.00					13.00
6	Coordination				4.00				2.00						6.00
7	Quality Control			2.00											2.00
8	Response to Comments			1.00	1.00		1.00								3.00
9	Project Management	4.00													4.00
10															0.00
11															0.00
Subtotal Hours		4.00	0.00	11.00	13.00	32.00	5.00	3.00	4.00	2.00	0.00	0.00	0.00	0.00	74.00
Rate		\$ 77.88	\$ -	\$ 52.88	\$ 42.09	\$ 36.63	\$ 25.72	\$ 62.50	\$ 32.69	\$ 25.50	\$ -	\$ -	\$ -	\$ -	
Subtotal Direct Labor		\$ 311.52	\$ -	\$ 581.68	\$ 547.17	\$ 1,172.16	\$ 128.60	\$ 187.50	\$ 130.76	\$ 51.00	\$ -	\$ -	\$ -	\$ -	\$ 3,110.39
Subtotal Burdened Labor @			2.91												\$ 9,051.23

8230 18 MTCE Project
Tampa International Airport

CE 0008

Voltair

Electrical Design

100% Design Fee

Project Fee Proposal - Hensel Phelps Team																
Main Terminal Curbside Expansion - Voltair																
HCAA Project Number 8240-19																
3/29/2019																
Scope/Task			Principal	PM	Engineer II	Engineer I	Sr. Designer	Designer	BIM Manager	CADD	Clerical	Sr Fire Protection Designer	Senior Plumbing Designer	BIM Coordinator	Clerical	Total
			Hours	Hours	Hours	Hours	Hours	Hours	Hours	Hours	Hours	Hours	Hours	Hours	Hours	Hours
Basic Design Services																
Task - 100% Design																
1	Design Coordination Meetings			2.00	4.00											6.00
2	Lighting Plan Development			2.00	4.00	4.00	4.00	4.00	4.00	4.00						26.00
3	Power Plan Development			2.00	4.00	4.00	4.00	4.00	4.00	4.00						26.00
4	Fire Alarm Coordination			2.00	4.00	4.00	4.00	4.00								18.00
5	Specification Development			2.00	4.00						2.00					8.00
6	Demolition Plan Development			2.00		4.00			4.00	4.00						14.00
7	Owner Coordination Meetings		4.00	4.00												8.00
8	QA/QC			4.00	8.00	4.00										16.00
9																0.00
10																0.00
11																0.00
12																0.00
13																0.00
14																0.00
15																0.00
16																0.00
Subtotal Hours			4.00	20.00	28.00	20.00	12.00	12.00	12.00	12.00	2.00	0.00	0.00	0.00	0.00	122.00
Rate			\$ 83.22	\$ 67.31	\$ 45.81	\$ 37.14	\$ 44.13	\$ 20.00	\$ 36.35	\$ 36.35	\$ 23.76	\$ 48.20	\$ 48.20	\$ 43.99	\$ 29.38	
Subtotal Direct Labor			\$ 332.88	\$ 1,346.20	\$ 1,282.68	\$ 742.80	\$ 529.56	\$ 240.00	\$ 436.20	\$ 436.20	\$ 47.52	\$ -	\$ -	\$ -	\$ -	\$ 5,394.04
Subtotal Burdened Labor @				2.30												\$ 12,406.29

8230 18 MTCE Project
Tampa International Airport

CE 0008

Lea & Elliott

APM System Planning

30% Design Fee

Project Fee Proposal - Hensel Phelps Team															
Main Terminal Curbside Expansion - Lea & Elliott															
HCAA Project Number 8240-19															
3/29/2019															
Scope/Task		Principal	PM	Sr AE	AE	Sr Design	Admin							Clerical	Total
		Hours	Hours	Hours	Hours	Hours	Hours	Hours	Hours	Hours	Hours	Hours	Hours	Hours	Hours
Basic Design Services															
Task - 30% Design															
1	Dan McFadden, PE	30.00													30.00
2	Sambit Bhattacharjee, PE			80.00											80.00
3	Guadalupe Murillo, PE		90.00												90.00
4	Alexis Perez, PE				200.00										200.00
5	Eduardo Cuadra					180.00									180.00
6	Barbara Soto						90.00								90.00
7															0.00
8															0.00
9															0.00
10															0.00
11															0.00
Subtotal Hours		30.00	90.00	80.00	200.00	180.00	90.00	0.00	0.00	0.00	0.00	0.00	0.00	0.00	670.00
Rate		\$ 96.53	\$ 69.92	\$ 87.38	\$ 61.13	\$ 32.89	\$ 24.19	\$ -	\$ -	\$ -	\$ -	\$ -	\$ -	\$ 29.38	
Subtotal Direct Labor		\$ 2,895.90	\$ 6,292.80	\$ 6,990.40	\$ 12,226.00	\$ 5,920.20	\$ 2,177.10	\$ -	\$ -	\$ -	\$ -	\$ -	\$ -	\$ -	\$ 36,502.40
Subtotal Burdened Labor @			2.93												\$ 106,952.03

8230 18 MTCE Project
Tampa International Airport

CE 0008

Hensel Phelps

CE 0008 - Design of Airside D Terminal Platform

Change Fee Proposal - Hensel Phelps Team - Summary Sheet

Main Terminal Curbside Expansion, New Energy Plant and Related Work

HCAA Project Numbers 8230-18-BCS, 8230-18-RCS, 8200-18, 8205-18-CEP, 8205-18-CEP, 8205-18-LDB, 8900-18, 8240-19

4/1/2019

Basic Design Services		30%	60%	90%	100%	Total	Construction	Total
Engineering & Preconstruction Services		Design Dev.	Design Dev.	Const. Docs	Final Docs	Part I	Administration	
Hensel Phelps	\$	-	\$ 27,797.18	\$ 27,797.18	\$ 19,224.55	\$ 74,818.91	\$ -	\$ 74,818.91
	\$	-	\$ -	\$ -	\$ -	\$ -	\$ -	\$ -
	\$	-	\$ -	\$ -	\$ -	\$ -	\$ -	\$ -
	\$	-	\$ -	\$ -	\$ -	\$ -	\$ -	\$ -
	\$	-	\$ -	\$ -	\$ -	\$ -	\$ -	\$ -
	\$	-	\$ -	\$ -	\$ -	\$ -	\$ -	\$ -
	\$	-	\$ -	\$ -	\$ -	\$ -	\$ -	\$ -
	\$	-	\$ -	\$ -	\$ -	\$ -	\$ -	\$ -
	\$	-	\$ -	\$ -	\$ -	\$ -	\$ -	\$ -
Design Phase Sub Total	\$	-	\$ 27,797.18	\$ 27,797.18	\$ 19,224.55	\$ 74,818.91	\$ -	\$ 74,818.91
Reimbursable Expenses		30%	60%	90%	100%	Total		Total
Hensel Phelps	\$	-	\$ 1,445.13	\$ 1,445.13	\$ 999.31	\$ 3,889.56		\$ 3,889.56
	\$	-	\$ -	\$ -	\$ -	\$ -		\$ -
	\$	-	\$ -	\$ -	\$ -	\$ -		\$ -
	\$	-	\$ -	\$ -	\$ -	\$ -		\$ -
	\$	-	\$ -	\$ -	\$ -	\$ -		\$ -
	\$	-	\$ -	\$ -	\$ -	\$ -		\$ -
	\$	-	\$ -	\$ -	\$ -	\$ -		\$ -
	\$	-	\$ -	\$ -	\$ -	\$ -		\$ -
Reimbursables Sub Total	\$	-	\$ 1,445.13	\$ 1,445.13	\$ 999.31	\$ 3,889.56		\$ 3,889.56
Total Fee, Allowances, Reimbursable Expenses	\$	-	\$ 29,242.31	\$ 29,242.31	\$ 20,223.86	\$ 78,708.47		\$ 78,708.47

**Main Terminal Curbside Expansion, New Energy Plant and Related Work
Reimbursables**

Change Fee Proposal - Hensel Phelps Team - Summary Sheet

Hensel Phelps

HCAA Project Number 8230-18

4/1/2019

Scope/Task				30%		60%		90%		100%		Total
		Rate	Unit (Type)	# Units	Subtotal	# Units	Subtotal	# Units	Subtotal	# Units	Subtotal	
Task - Reimbursables												
1	Vehicle & Fuel, Maintenance and Repairs (\$1,250/Month)	\$ 7.81	Hour		\$ -	160.00	\$ 1,250.00	160.00	\$ 1,250.00	110.00	\$ 859.38	\$ 3,359.38
2	Auto Allowance (\$700/Month)	\$ 4.38	Hour		\$ -	20.00	\$ 87.50	20.00	\$ 87.50	15.00	\$ 65.63	\$ 240.63
3	Cell Phone (\$82/Month)	\$ 0.51	Hour		\$ -	210.00	\$ 107.63	210.00	\$ 107.63	145.00	\$ 74.31	\$ 289.56
4					\$ -		\$ -		\$ -		\$ -	\$ -
5					\$ -		\$ -		\$ -		\$ -	\$ -
6					\$ -		\$ -		\$ -		\$ -	\$ -
7					\$ -		\$ -		\$ -		\$ -	\$ -
8					\$ -		\$ -		\$ -		\$ -	\$ -
9					\$ -		\$ -		\$ -		\$ -	\$ -
10					\$ -		\$ -		\$ -		\$ -	\$ -
11					\$ -		\$ -		\$ -		\$ -	\$ -
	Total				\$ -	390.00	\$ 1,445.13	390.00	\$ 1,445.13	270.00	\$ 999.31	\$ 3,889.56



May 21, 2019

Hillsborough County Aviation Authority
Attn: Brian Rumble
Program Manager
Tampa International Airport

Subject: Request for Change Order CE#0009 & #0009.1 – Owner Directive – Design of
Baggage Route for Airside D Terminal
8230 18 – MTCE Project
Tampa International Airport

Dear Brian:

Hensel Phelps Construction Co. is hereby submitting a Request for Change Order (RCO) with Change Estimate #0009 & #0009.1. Included are costs to design the future Airside D Baggage routing in conjunction with the Red Side Project as part of the MTCE Project as directed by the Owner. The scope includes baggage input points and direct feeds from the northwest corner of the current ticketing level destined for Airside D. Excluded is the design of input points from any ticket counter in the east half of the ticket level as that is a future HCAA project. This proposal does not include any baggage system component design, only validity of appropriate routing and spacing of baggage systems.

The total costs are separated into Design to 30% and 100% Construction Documents. The values are as follows:

CE #0009	30% Design Development	\$ 121,677.27
CE #0009.1	100% Construction Documents	\$ 155,107.40
	Airside D Baggage Routing Design Total	\$ 276,784.67

The appropriate documentation associated with these values has been incorporated into this proposal.

Please do not hesitate to contact the project team with any questions or concerns.

Sincerely,
HENSEL PHELPS CONSTRUCTION CO.

Drew Krizman

Drew Krizman
Project Manager

c: 8016169, DK, SG



HENSEL PHELPS

Plan. Build. Manage.

6557 Hazeltine National Drive
Suite One
Orlando, FL 32822
407.856.2400

April 2, 2019

Hillsborough County Aviation Authority
Attn: Brian Rumble
Program Manager
Tampa International Airport

Subject: Request for Change Order CE#0009 – Owner Directive – Design of Baggage
Route for Airside D Terminal
8230 18 – MTCE Project
Tampa International Airport

Dear Brian:

Hensel Phelps Construction Co. is hereby submitting a Request for Change Order (RCO) with Change Estimate #0009. Included are costs to design the future Airside D Baggage routing in conjunction with the Red Side Project as part of the MTCE Project as directed by the Owner. The scope includes baggage input points and direct feeds from the northwest corner of the current ticketing level destined for Airside D. Excluded is the design of input points from any ticket counter in the east half of the ticket level as that is a future HCAA project.

The total cost for this RCO is \$276,784.67 including all documentation to substantiate the additional cost requested.

Please do not hesitate to contact the project team with any questions or concerns.

Sincerely,
HENSEL PHELPS CONSTRUCTION CO.

Drew Krizman

Drew Krizman
Project Manager

c: 8016169, DK, SG

CE: <u>0009</u>	Change Estimate Summary
------------------------	--------------------------------



HENSEL PHELPS
Plan. Build. Manage.

8230 18 - MTCE Project
Tampa International Airport

Company	Description of Scope	Change Estimate Totals		
		30%	60% - 100%	Total
HNTB Architectural	Architectural Design	\$ 71,454.63	\$ 91,820.12	\$ 163,274.75
VTC	Baggage Design	\$ 50,222.64	\$ 63,287.28	\$ 113,509.92
		\$ -	\$ -	\$ -
		\$ -	\$ -	\$ -
		\$ -	\$ -	\$ -
		\$ -	\$ -	\$ -
		\$ -	\$ -	\$ -
		\$ -	\$ -	\$ -
		\$ -	\$ -	\$ -
		\$ -	\$ -	\$ -
		\$ -	\$ -	\$ -
		\$ -	\$ -	\$ -
		\$ -	\$ -	\$ -
		\$ -	\$ -	\$ -
SUBTOTAL:		\$ 121,677.27	\$ 155,107.40	\$ 276,784.67

INITIATING DOCUMENTS

Owner Directive

The Owner has decided to include the design of the future Airside D Baggage routing into the MTCE Project. This is to be treated as an extension of the Red Side Project and will be designed, bid and built in concert with the Red Side Project. Baggage input points from the northwest corner of the current ticketing level destined for Airside D will be planned and designed for future direct feeds to the future Airside D building for CBIS and bag sortation. In addition, HCAA may want the ability to have other east half of the ticket level ticket locations input into this Airside D system. The scope of the proposal however does not include the ability to input bags from any ticket counter in the east half of the ticket level as that is a future HCAA project. Only a direct feed from the designated Northwest section of the ticket level to Airside D is included.

Tampa international airport
Main Terminal Curbside Expansion Project
Scope of work for
CE009 Airside D APM Station Baggage System Project task

Baggage handling system planning and design- Baggage input points from the northwest corner of the current ticketing level destined for Airside D will be planned and designed for future direct feeds to the future Airside D building for CBIS and bag sortation. In addition, HCAA may want the ability to have other east half of the ticket level ticket locations input into this Airside D system. The scope of the proposal however does not include the ability to input bags from any ticket counter in the east half of the ticket level, as that is a future HCAA project. Only a direct feed from the designated northwest section of the ticket level to Airside D is included. See the attached drawing. The baggage system design and the design for the right of way for the outbound baggage handling system from the ticketing level through to the underside of the transfer level floor / below or adjacent to APM station floor will be created. Estimate of electrical load requirements for bag system will be provided and switchgear would be reserved for those future loads. The architectural right of way and baggage system designs are part of this task. Any building MEP, IT, Fire protection or other building systems that may have to be moved are included in the Airside D APM station project as that are integrated with that building.

Ticketing Level

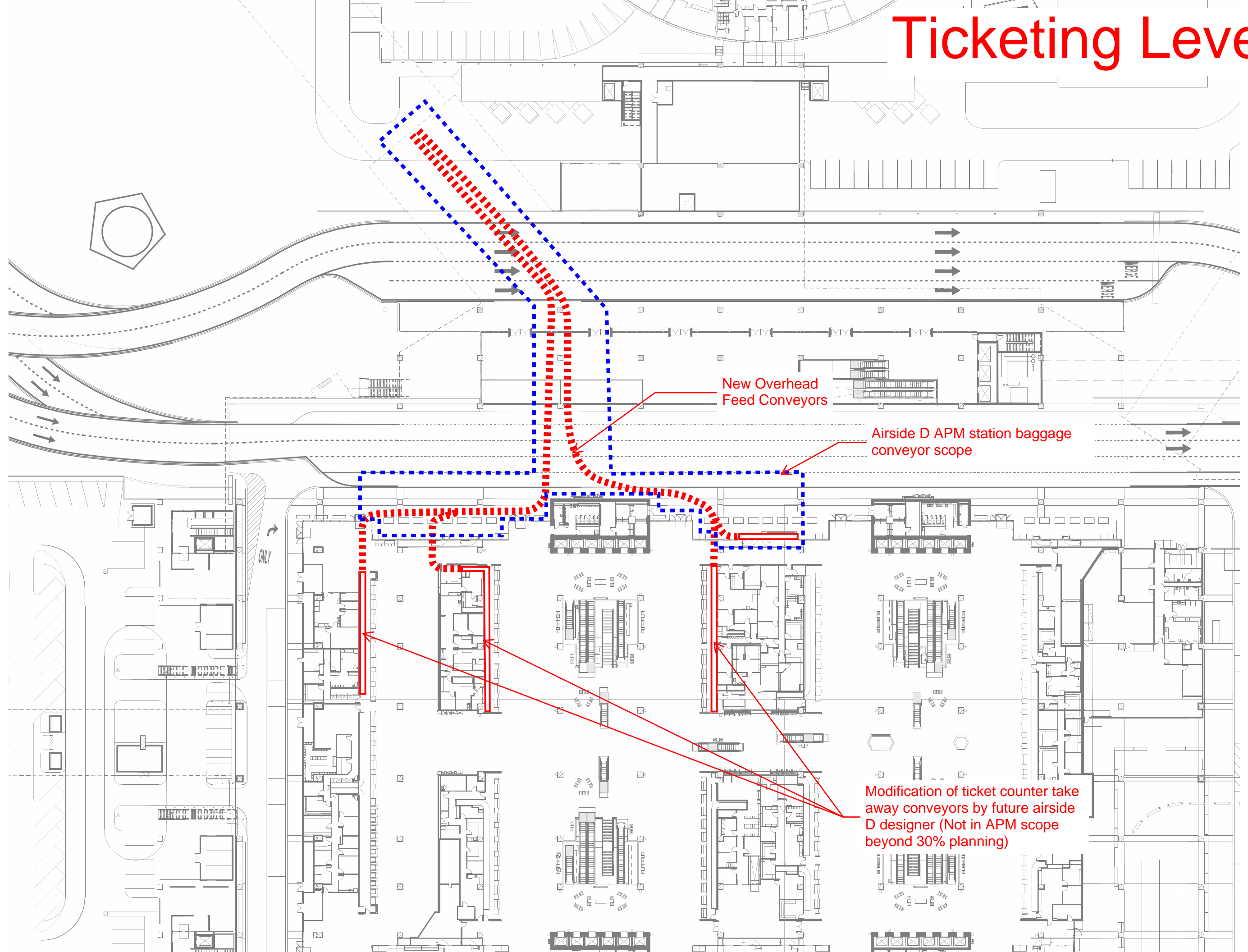

New Overhead
Feed Conveyors

Airside D APM station baggage
conveyor scope

Modification of ticket counter take
away conveyors by future airside
D designer (Not in APM scope
beyond 30% planning)

Transfer Level

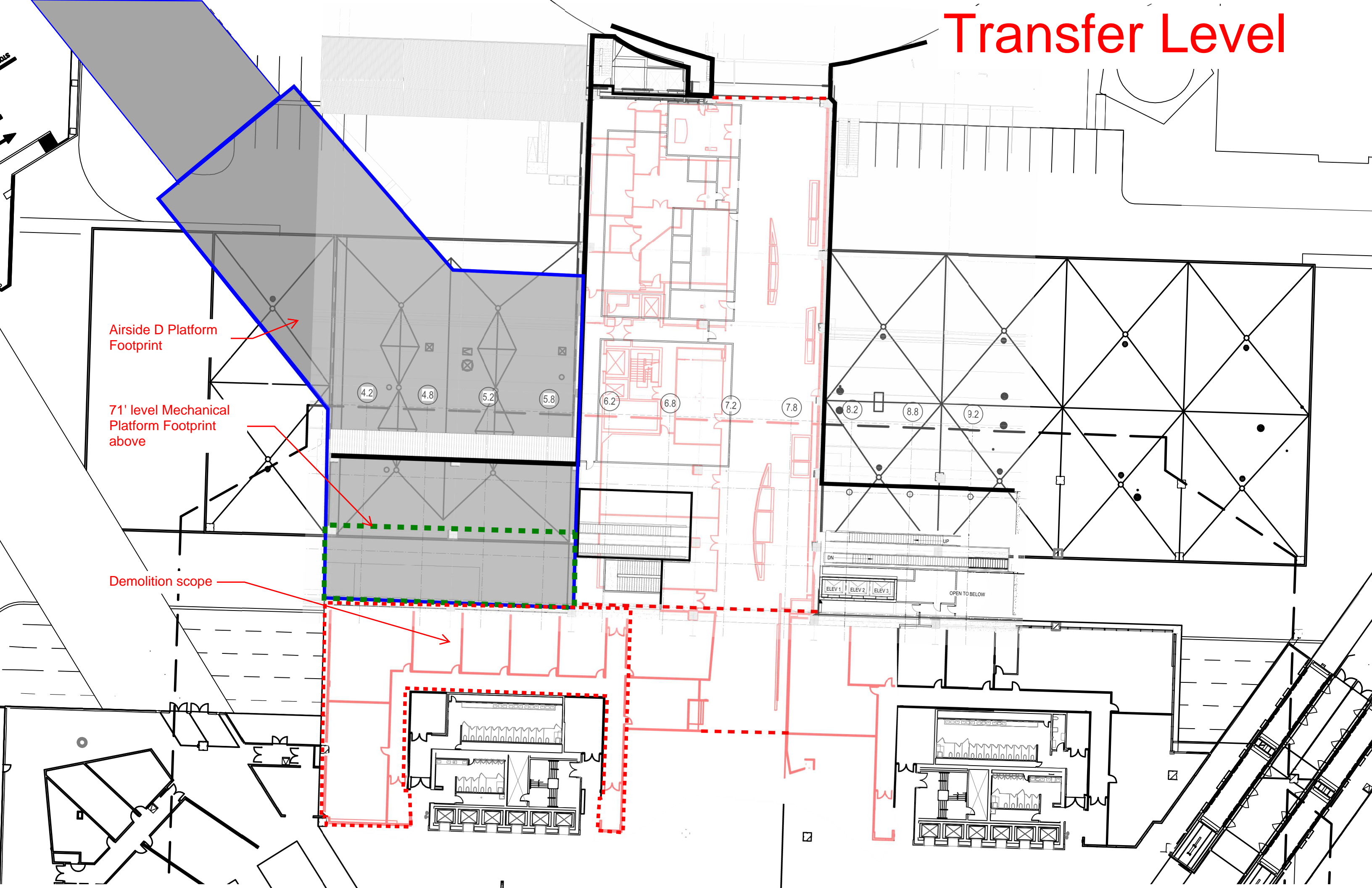

Airside D Platform Footprint

71' level Mechanical Platform Footprint above

Demolition scope

SUBCONTRACTOR PRICING

- 1 HNTB Architectural
- 2 VTC

8230 18 MTCE Project
Tampa International Airport

CE 0009

HNTB Architectural

Architectural Design

30% Design Fee

Main Terminal Curbside Expansion, New Energy Plant and Related Work 30% Design

Project Fee Proposal - Hensel Phelps Team												
Main Terminal Curbside Expansion - HNTB Arch												
HCAA Project Number 8230-18												
3/13/2019												
Scope/Task		Arch PM	Arch Des. Dir	Arch Sr. Des.	Arch Sr. PA	Arch Jr. Des.	Tech. Staff	Spec	Admin	QC		Total
		Hours	Hours	Hours	Hours	Hours	Hours	Hours	Hours	Hours		
Basic Design Services												
Task - 30% Design												
1	Design Management	4.00	2.00	16.00	12.00	16.00	7.00					57.00
2	Document Coordination	4.00	2.00	16.00	12.00	16.00	7.00					57.00
3	Drawings/BIM	10.00	5.00	40.00	31.00	41.00	16.00					143.00
4	Studies/Phasing	18.00	9.00	72.00	55.00	74.00	29.00					257.00
5	Consultant Coordination	4.00	2.00	16.00	12.00	16.00	7.00					57.00
6	QA/QC	1.00		1.00						4.00		6.00
7												0.00
8												0.00
9												0.00
10												0.00
11												0.00
Subtotal Hours		41.00	20.00	161.00	122.00	163.00	66.00	0.00	0.00	4.00		577.00
Rate		\$ 73.50	\$ 84.00	\$ 45.68	\$ 48.30	\$ 28.35	\$ 26.25	\$ 47.25	\$ 37.28	\$ 97.65		
Subtotal Direct Labor		\$ 3,013.50	\$ 1,680.00	\$ 7,354.48	\$ 5,892.60	\$ 4,621.05	\$ 1,732.50	\$ -	\$ -	\$ 390.60		\$ 24,684.73
Subtotal Burdened Labor @			2.84									\$ 70,104.63

8230 18 MTCE Project
Tampa International Airport

CE 0009

VTC

Baggage Design

30% Design Fee

Project Fee Proposal - Hensel Phelps Team											
Main Terminal Curbside Expansion - VTC											
HCAA Project Number 8230-18											
3/13/2019											
Scope/Task		Principal	Mod Engr	PM	Systems Eng	Sr. Design	Cont/Elec	Designer	Field Engr	Proj Coord	Total
		Hours	Hours	Hours	Hours	Hours	Hours	Hours	Hours	Hours	Hours
Basic Design Services											
Task - 30% Design											
1	Basis of Design Report (BDR)	2.00	4.00	8.00	12.00						26.00
2	BHS Dwgs, ROW, Catwalk (in Revit)			4.00	20.00	40.00		100.00	8.00	2.00	174.00
3	BHS Electrical Load Estimate						4.00				4.00
4	Site Orientation Trip (one)			18.00		18.00		18.00			54.00
5	Owner Meetings (two)			36.00		36.00		36.00			108.00
6	Weekly Coordination Mtgs			8.00		8.00		8.00			24.00
7	White Paper - ICS, Self-checkin Technologies			4.00	4.00	2.00					10.00
8											0.00
9											0.00
10											0.00
11											0.00
	Subtotal Hours	2.00	4.00	78.00	36.00	104.00	4.00	162.00	8.00	2.00	400.00
	Rate	\$ 86.54	\$ 63.46	\$ 48.08	\$ 45.19	\$ 37.02	\$ 49.52	\$ 29.81	\$ 26.44	\$ 46.49	
	Subtotal Direct Labor	\$ 173.08	\$ 253.84	\$ 3,750.24	\$ 1,626.84	\$ 3,850.08	\$ 198.08	\$ 4,829.22	\$ 211.52	\$ 92.98	\$ 14,985.88
	Subtotal Burdened Labor @		3.00								\$ 44,957.64

90% Design Fee

Project Fee Proposal - Hensel Phelps Team												
Main Terminal Curbside Expansion - VTC												
HCAA Project Number 8230-18												
3/13/2019												
Scope/Task		Principal	Mod Engr	PM	Systems Eng	Sr. Design	Cont/Elec	Designer	Field Engr	Proj Coord		Total
Basic Design Services		Hours	Hours	Hours	Hours	Hours	Hours	Hours	Hours	Hours	Hours	
Task - 90% Design												
1	BHS Dwgs, ROW, Catwalk, Spec	2.00		8.00	16.00	50.00	8.00	60.00	16.00	3.00		163.00
2	IFB Documents											0.00
3	Permit Support											0.00
4	Update MCP Panel Locations						8.00					8.00
5	Bidding Support	1.00		2.00	4.00	4.00				4.00		15.00
6	Bi-weekly Design Team Mtgs			5.00		5.00		5.00				15.00
7												0.00
8												0.00
9												0.00
10												0.00
11												0.00
	Subtotal Hours	3.00	0.00	15.00	20.00	59.00	16.00	65.00	16.00	7.00		201.00
	Rate	\$ 86.54	\$ 63.46	\$ 48.08	\$ 45.19	\$ 37.02	\$ 49.52	\$ 29.81	\$ 26.44	\$ 46.49		
	Subtotal Direct Labor	\$ 259.62	\$ -	\$ 721.20	\$ 903.80	\$ 2,184.18	\$ 792.32	\$ 1,937.65	\$ 423.04	\$ 325.43		\$ 7,547.24
	Subtotal Burdened Labor @		3.00									\$ 22,641.72



HENSEL PHELPS

Plan. Build. Manage.

6557 Hazeltine National Drive
Suite One
Orlando, FL 32822
407.856.2400

May 21, 2019

Hillsborough County Aviation Authority
Attn: Brian Rumble
Program Manager
Tampa International Airport

Subject: Request for Change Order CE#013 – Baggage Handling System Tunnel
8230 18 – MTCE Project
Tampa International Airport

Dear Brian:

Hensel Phelps Construction Co. is hereby Change Estimate #013. Included are costs to design the demolition and necessary structural modifications to an existing baggage tunnel that was discovered underneath the Long-Term Parking Garage and Blue Side Rental Car Facility. This scope was not included in the original design scope for the MTCE Project.

The total cost is \$14,493.30 including all documentation to substantiate the additional cost requested. These costs do not include and Construction Administration costs as they will be incorporated into the Part 2 Agreement at a later date.

Please do not hesitate to contact the project team with any questions or concerns.

Sincerely,
HENSEL PHELPS CONSTRUCTION CO.

Drew Krizman

Drew Krizman
Project Manager for Construction

c: 8016169, DK, SG

CE: 0013

Change Estimate Summary



HENSEL PHELPS
Plan. Build. Manage.

8230 18 - MTCE Project
Tampa International Airport

Company	Description of Scope	Change Estimate Totals	
MCE	Structural Design	\$	11,362.20
HNTB Structural	Structural Design	\$	3,131.10
		\$	-
		\$	-
		\$	-
		\$	-
		\$	-
		\$	-
		\$	-
		\$	-
		\$	-
SUBTOTAL:		\$	14,493.30

INITIATING DOCUMENTS

Owner Directive

An abandoned baggage tunnel was found running underneath the location of the proposed site for the future Blue Side VCB. Due to the locations of the piers and foundations of the future building this tunnel will need to be demoed during the Enabling phase of the MTCE project. Costs are included to design the demolition and necessary structural modifications to the existing baggage tunnel. This scope was not included in the original design scope for the MTCE project.

- 0.0 GENERAL DEMOLITION NOTES:**
- 0.0.1 DEMOLITION CONSISTS OF PERFORMING ALL DEMOLITION OF EXISTING CONSTRUCTION WHICH IN ITS PRESENT FORM WILL INTERFERE WITH THE COMPLETED NEW CONSTRUCTION AND TO PERFORM ANY OTHER CUTTING OR PATCHING OF EXISTING CONSTRUCTION AS SHOWN ON THE DRAWINGS.
 - 0.0.2 CLEAN BASE BUILDING CURTAIN WALL GLASS, FRAMES AND SILLS OR DRIPS, SPILLS AND DEBRIS. REPAIR ANY DAMAGE CAUSED BY DEMOLITION.
 - 0.0.3 ALL EXISTING DOORS, FRAMES, DOOR HARDWARE, LIGHT FIXTURES, SWITCHES NOT BEING REUSED FOR THIS PROJECT SHALL BE STORED FOR THE TENANT OR OWNER AS REQUIRED. CONSULT WITH ARCHITECT FOR VERIFICATION.
 - 0.0.4 PATCH ALL FLOOR, CEILING AND WALL SURFACES AS WELL AS ALL ADJACENT SURFACES AFFECTED BY DEMOLITION WITH SIMILAR MATERIALS AS NECESSARY TO ACHIEVE UNIFORM, NEW APPEARANCE (I.E. GYPSUM WALL BOARD PERIMETER WALLS, DEMISING WALLS, CORE, ETC.). PATCHES SHALL BE IMPERCEPTIBLE.
 - 0.0.5 IN ALL AREAS WHERE DEMOLITION (REMOVAL OF PARTITIONS, ETC.) CAUSES UNEVENNESS IN THE FLOOR, THE CONTRACTOR SHALL PATCH TO LEVEL THE FLOOR TO RECEIVE FINISHED FLOORING.
- 0.1 DEMOLITION INCLUDES BUT IS NOT LIMITED TO THE FOLLOWING:
- 0.1.1 FURTHER DEMOLITION ADMINISTRATIVE REQUIREMENTS ARE TO BE PROVIDED PER SPECIFICATIONS SHEET OR MANUAL. IF NEITHER IS PROVIDED, PLEASE CONTACT ARCHITECT FOR VERIFICATION IMMEDIATELY.
 - 0.1.2 PARTITIONS
 - A. REMOVAL OF EXISTING PARTITIONS, INCLUDING DOORS, FRAMES, AND THERMOSTATS, ELECTRICAL WITHIN PARTITIONS SHALL BE REMOVED AS INDICATED ON THE DRAWINGS. GC TO RELOCATE ANY THERMOSTAT TO A LOCATION SUITABLE BY ARCHITECT AND MEP ENGINEER.
 - B. ALL EXISTING DOORS DESIGNATED FOR REMOVAL INCLUDING FRAMES SHALL BE REUSED WHERE THE SAME TYPE DOOR IS APPLICABLE U.N.O. ALL REUSED DOORS TO BE REFINISHED / REPAINTED AS SPECIFIED WITH BLEMISHES REPAIRED. ALL EXISTING HARDWARE SHALL BE RETAINED FOR REUSE AS NOTED IN THE DEMOLITION PLAN STANDARDS. ANY MATERIALS SHALL BE GROUPED AND STACKED NEATLY IN ONE LOCATION. PROTECT ALL ITEMS FROM DAMAGE. IF ITEMS REMOVED ARE NOT REQUIRED BY EITHER OWNER OR TENANT THEY SHALL BECOME THE PROPERTY OF THE CONTRACTOR AND REMOVED FROM THE SITE AS WORK PROGRESSES.
 - 0.1.3 CEILING
 - A. REMOVE SPECIFIED LIGHTS (REFER TO CEILING PLAN IF REQUIRED)
 - B. EXISTING LIGHT FIXTURES, DIFFUSERS, EXIT SIGNS, ETC. SHALL BE REUSED AS NOTED IN DEMOLITION PLAN STANDARDS IF IN GOOD CONDITION. PROTECT AND NUMBER IN ONE LOCATION. COORDINATE WITH ARCHITECT.
 - 0.1.4 FINISHES
 - A. EXISTING FINISHES TO REMAIN U.N.O.
 - 0.1.5 POWER AND COMMUNICATION
 - A. ALL ELECTRICAL, TELEPHONE, DATA AND PLUMBING ITEMS NOT TO REMAIN IN EXISTING LOCATION SHALL BE COMPLETELY REMOVED. REMAINING HOLES SHALL BE CAPPED AND PATCHED TO PROVIDE A FLUSH SURFACE THAT WILL MATCH ADJACENT SURFACES.
 - 0.1.6 HVAC
 - A. REMOVE ALL EXISTING MECHANICAL SYSTEMS U.N.O.
 - B. REFER TO MECHANICAL DRAWINGS FOR MORE DETAILS.
 - 0.1.7 PLUMBING
 - A. SPRINKLER MAIN PIPING AND HEADS ARE TO REMAIN FOR FUTURE RELOCATION U.N.O.
 - B. REFER TO FIRE PROTECTION DRAWINGS AND PLUMBING DRAWINGS.
 - 0.2.0 DEBRIS REMOVAL
 - A. CONDUCT DEMOLITION OPERATION AND THE REMOVAL OF DEBRIS AND EQUIPMENT TO INSURE MINIMUM INTERFERENCE WITH EXISTING BUSINESS OPERATION. CONSULT WITH BUILDING OWNER FOR ANY RULES AND REGULATIONS REGARDING HOURS, DUMPSTERS AND REMOVAL. ELEVATOR MUST BE PROTECTED AND TIMING MUST BE COORDINATED WITH BUILDING OWNER. INSURE PROTECTION OF PERSONS AROUND THE DEMOLITION AREA. USE TEMPORARY ENCLOSURES AND OTHER SUITABLE METHODS TO LIMIT THE AMOUNT OF DUST AND DIRT RISING AND SCATTERING IN THE AIR TO THE LOWEST PRACTICAL LEVEL. CONTRACTOR SHALL KEEP DEMOLITION DEBRIS OUT OF THE BUILDING CORRIDORS.
 - B. RELOCATION OF ITEMS INVOLVED IN THE WORK IS SUBJECT TO THE CONTRACTOR'S ABILITY TO DO SO WITHOUT PERMANENTLY DAMAGING OR MARRING THE ITEMS TO BE RELOCATED. IF THE CONTRACTOR IS UNABLE TO RELOCATE THE ITEMS AS PRESCRIBED, SUBSTITUTION OF NEW MATERIAL IN LIEU OF RELOCATION IS ACCEPTABLE. CONTRACTOR MAY ELECT TO USE NEW MATERIALS TO MATCH EXISTING IN LIEU OF RELOCATION AT HIS OWN CONVENIENCE FOR NO ADDITIONAL COST.
 - C. DEBRIS RESULTING FROM THE DEMOLITION AND CONSTRUCTION SHALL BE REMOVED FROM THE BUILDING SITE ON A DAILY BASIS.
 - D. CLEAN ADJACENT WORK OF DUST, DIRT, AND DEBRIS CAUSED BY DEMOLITION OPERATIONS, RETURN ADJACENT AREAS TO CLEAN CONDITION (SIMILAR TO PRIOR DEMOLITION) AFTER COMPLETION.
 - 0.3.0 MISCELLANEOUS REQUIREMENTS
 - 0.3.1 IF CONTRACTOR DISCOVERS EXISTING CONDITIONS WHICH ARE NOT INDICATED ON THE DRAWINGS, CONTRACTOR SHALL NOTIFY THE ARCHITECT IMMEDIATELY BOTH VERBALLY AND IN WRITING PRIOR TO PROCEEDING WITH THAT PORTION OF THE WORK.
 - 0.3.2 EACH SPECIFIC ITEM OF CUTTING, PATCHING, OR FITTING IS NOT NECESSARILY DESCRIBED INDIVIDUALLY HEREIN. ABSENCE OF A SPECIFIC INSTRUCTION FOR CUTTING, PATCHING, OR FITTING SHALL NOT RELIEVE THE CONTRACTOR FROM RESPONSIBILITY TO PERFORM AS REQUIRED COMPLETING THE WORK.

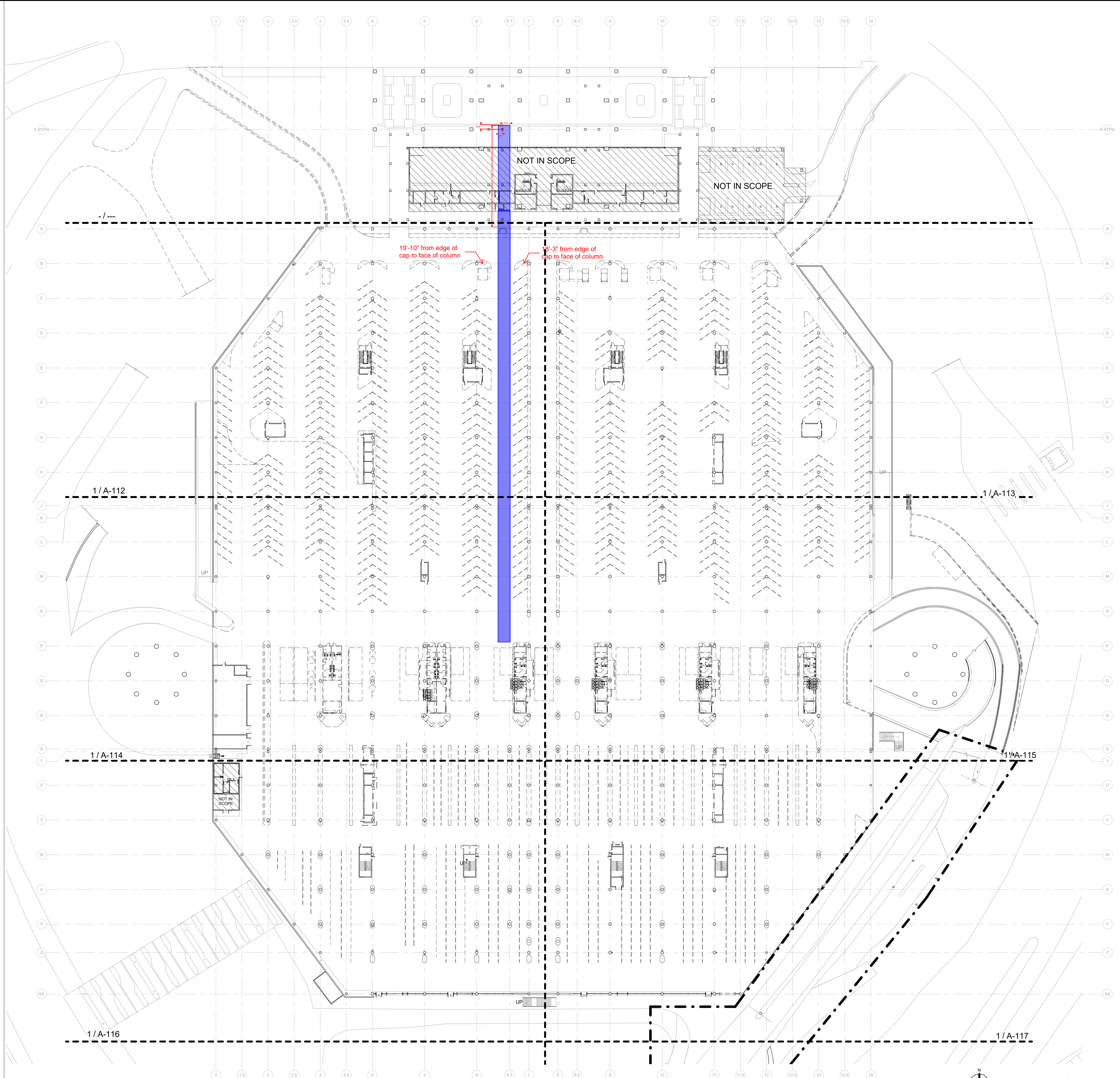

DEMOLITION PLAN GENERAL NOTES
1/8" = 1'-0"

FIRST FLOOR FLOOR PLAN
1" = 40'-0"

BY	
REVISIONS	
DATE	
KEVIN SMITH AR0011656	
PERMIT DRAWINGS: 12.22.17	
RECLAIM LONG TERM PARKING GARAGE LEVELS 1 AND 2 ADDRESS: 4000 GEORGE J. BEAN PKWY., TAMPA, FL 33607	
SHEET TITLE DEMOLITION PLAN LEVEL 01	
DESIGNED:	MM
DRAWN:	KZ
CHECKED:	
HCAA NO.:	6505 17
JOB NO.:	17023
DATE:	
A-110	
SHEET NO.:	

SUBCONTRACTOR PRICING

- 1 MCE
- 2 HNTB Structural

8230 18 MTCE Project
Tampa International Airport

CE 0013

MCE

Structural Design

8230 18 MTCE Project
Tampa International Airport

CE 0013

HNTB Structural

Structural Design



HENSEL PHELPS

Plan. Build. Manage.

6557 Hazeltine National Drive
Suite One
Orlando, FL 32822
407.856.2400

May 21, 2019

Hillsborough County Aviation Authority
Attn: Brian Rumble
Program Manager
Tampa International Airport

Subject: Request for Change Order CE#0017 – Owner Directive – Blue Side Pedestrian
Bridge Phasing
8230 18 – MTCE Project
Tampa International Airport

Dear Brian:

Hensel Phelps Construction Co. is hereby submitting Change Estimate #0017. Included are costs to phase the construction of the Blue Side Vertical Circulation Building and Bridge from the Long-Term Parking Garage. This scope was not included in the original scope for the MTCE project.

The total cost is \$285,113.70 including all documentation to substantiate the additional cost requested. These costs do not include any Construction Administration costs as they will be incorporated into the Part 2 Agreement at a later date.

Please do not hesitate to contact the project team with any questions or concerns.

Sincerely,
HENSEL PHELPS CONSTRUCTION CO.

Drew Krizman

Drew Krizman
Project Manager for Construction

c: 8016169, DK, SG

CE: 0017**Change Estimate Summary****HENSEL PHELPS**
Plan. Build. Manage.8230 18 - MTCE Project
Tampa International Airport

Company	Description of Scope	Change Estimate Totals	
Hensel Phelps	General Contractor		74,524.74
HNTB Structural	Structural Design	\$	35,054.12
HNTB Architectural	Architectural Design	\$	22,925.90
HNTB Civil	Civil Design	\$	52,150.32
Henderson Consulting	Code Compliance	\$	39,237.00
Voltair	Electrical Design	\$	25,321.94
MCE	Structural Design	\$	20,840.73
Selbert Perkins	Signage Design	\$	15,058.95
		\$	-
		\$	-
		SUBTOTAL:	\$ 285,113.70

INITIATING DOCUMENTS

Owner Directive

The design of phased construction of the Blue Side VCB and bridge from the Long Term Parking Garage due to keeping one of the transfer level bridges open to the public during construction until the new central bridge is constructed.

Tampa International Airport MTCE Project

Scope of Blue Side Ped Bridge Phasing

March 15, 2019

HCAA instructed the HP DB Team that HCAA has decided to move forward and build the Blue side project is a phased construction. This is to keep pedestrians transiting to and from the Main terminal and the Long-Term Parking Garage (LTPG) by retaining the east transfer level pedestrian bridge until the “western 2/3” of the Blue vertical circulation building structure is up and a new center pedestrian bridge and pathway is created all the way to the main terminal space through the Suite B area.

This work is not in the scope, schedule and fee in the original contract.

This change creates many design and construction issues. These issues must be solved mostly sequentially. Steps including early input from the Owner and for the City of Tampa before a design can be executed. Many disciplines are impacted by this change. The following are the issues involved with this change in chronological order:

1. Exact phase lines must be determined for both the VCB, Bridge, driveway canopy and civil site work for each discipline. Each may be slightly different.
2. Exact Transfer Level phasing lines (paths) must be determined by how we route pedestrians through the partially constructed VCB transfer level and on through Suite B
 - a. This requires meetings and approvals with the Owner
3. Life safety system concept conditions must be described for a Temporary Certificate Occupancy for the pathway through existing east pedestrian bridge during construction; and new center pedestrian bridge.
4. Life safety analysis and exiting and a potential rated walls concept must be generated to communicate with the City. This will require an AMMR variance process with the City of Tampa Development Services. A report assuring the City that all fire/life safety and smoke and fire issues are factored in with the execution of the construction and the life safety of all people using the existing and temporary paths are sufficient.
5. Meet with City of Tampa to work out acceptable conditions. This most likely will take two meetings. The City will have comments and ask the DB team to come back with revised concept plans before we have an approved plan to continue design.
6. Once the City provides conditions for approval; the design can start in earnest:
7. Design efforts:
 - a. General
 - i. Description of phasing sequence in Contract docs -Division One
 - ii. Description City of Tampa requirements in Contract docs
 - iii. Conditions of TCO at transfer level pathway
 - b. Structural
 - i. Structural analysis and calculations for entire building needs to be 90% complete, then,

- ii. A separate structural analysis and calculations for the “western 2/3 building” to prove this portion of the building can stand alone. The City may require two set of structural model analysis and calculations.
- iii. Design temporary girts and structural system to attach a temporary enclosure wall on the east end of phase one. Assume metal studs and watertight dens board wall on east end. Assume wall will be structurally designed.
- iv. Added structural design for added bracing and strengthening of foundations of new western 2/3 building.
- v. Structural Phasing drawings.
- vi. Phasing details.
- vii. Phasing notes and specs.

c. Architectural – (Final phasing plans/Revit models and backgrounds must be complete before all remaining sub disciplines can start their work.)

- i. Phasing drawings all levels and sections.
- ii. Transfer level showing multiple mini phases (pathway shifting).
- iii. Phasing details. Temporary transfer/suite B wall sections, flooring, ceilings, signage.
- iv. Waterproofing enclosure details.
 - 1. Design temporary watertight wall on east end of phase one, with all required details and flashing.

d. HVAC

- i. Permanent A/C in bridge.
- ii. Temporary A/C in transfer level in VCB during phasing.
- iii. Phasing drawings and details.

e. Fire protection

- i. Meeting to meet with City to understand extent of an operation of sprinkler system in the transfer level or elsewhere in western 2/3 bldg.
- ii. Design system as temporary in the transfer level of the VCB.
- iii. Design system in bridge as permanent.
- iv. Tie into a temporarily existing main terminal sprinkler system for temp pathway.
- v. Phasing drawings and details.

f. Electrical

- i. Fire alarm. Tie into existing as temporary. Lighting in Pedestrian bridge, to be permanent.
- ii. Temporary Lighting in Transfer level VCB.
- iii. Permanent power for bridge A/C and air handling unit in garage. Temp power for any temp A/C at transfer level.
- iv. Power and lighting now must be fed from a new source (from garage) because electrical rooms in VCB are not complete.
- v. Phasing drawings and details.

g. IT/Low Voltage

- i. Public PA Evacuation system tied temporarily into main terminal.
 - ii. Phasing drawings.
 - iii. Phasing details.
- h. Signage
 - i. Temporary signs for each mini-phase movement of pathway at transfer level and at LTPG.
 - ii. Phasing drawings and details and specs.
- i. Civil Bridge design
 - i. A separate structural analysis and calculations for the “western 2/3 of bridge”. The City may require two set of structural model analysis and calcs.
 - ii. Phasing plans.
 - iii. Phasing details at structure.
 - iv. Phasing specs.
- j. Canopy Structure
 - i. A separate structural analysis and calculations for the “western 2/3 canopy”. The City may require two set of structural model analysis and calcs.
 - ii. Phasing drawings for temporary bracing.
 - iii. Phasing details.
 - iv. Temporary Structural bracing details.
- k. Civil drawings at grade and sub grade
 - i. Phasing drawings.
 - ii. Phased drainage system design to maintain drainage.
 - iii. Design parameters for at grade and below grade work to allow east ped bridge demolition area impact below. Re-route of utilities.
- l. Fire life safety analysis
 - i. Code Analysis Reports (as described above) needed to prove to City of Tampa the plan meets the code intent for the existing pedestrian bridge and the temporary access at transfer level through the partially completed VCB Building.

SUBCONTRACTOR PRICING

- 1 Hensel Phelps
- 2 HNTB Structural
- 3 HNTB Architectural
- 4 HNTB Civil
- 5 Henderson Consulting
- 6 Voltair
- 7 MCE
- 8 Selbert Perkins

8230 18 MTCE Project
Tampa International Airport

CE 0017

Hensel Phelps

General Contractor

90% Design Fee

Main Terminal Curbside Expansion, New Energy Plant and Related Work 90% Design

Project Fee Proposal - Hensel Phelps Team											
Main Terminal Curbside Expansion - Hensel Phelps											
HCAA Project Number 8230-18											
3/18/2019											
Scope/Task		Gen Sup	Project Sup	Scheduler	VDC Mgr	VDC Eng.	Proj Mgr				Total
Basic Design Services		Hours	Hours	Hours	Hours	Hours	Hours	Hours	Hours	Hours	
Task - 90% Design											
1	BIM Model Development	0			40	80					120.00
2	Bridge Phasing Development	40	160								200.00
3	Bridge Phasing Design Review	40	160								200.00
4	Permitting Reviews						40.00				40.00
5	Project Schedule Development										0.00
6											0.00
7											0.00
8											0.00
9											0.00
10											0.00
11											0.00
	Subtotal Hours	80.00	320.00	0.00	40.00	80.00	40.00	0.00	0.00	0.00	560.00
	Rate	\$ 57.51	\$ 51.88	\$ 49.13	\$ 41.62	\$ 34.39	\$ 44.51				
	Subtotal Direct Labor	\$ 4,600.80	\$ 16,601.60	\$ -	\$ 1,664.80	\$ 2,751.20	\$ 1,780.40	\$ -	\$ -	\$ -	\$ 27,398.80
	Subtotal Burdened Labor @		2.72								\$ 74,524.74

8230 18 MTCE Project
Tampa International Airport

CE 0017

HNTB Structural

Structural Design

100% Design Fee

Main Terminal Curbside Expansion, New Energy Plant and Related Work 100% Design
--

Project Fee Proposal - Hensel Phelps Team											
Main Terminal Curbside Expansion - HNTB Struct											
HCAA Project Number 8230-18											
3/18/2019											
Scope/Task		Sr. Struct	Proj Struct	Struct E.	Sr. Tech	Tech.	Admin				Total
		Hours	Hours	Hours	Hours	Hours	Hours	Hours	Hours	Hours	
Basic Design Services											
Task - 100% Design											
1	Blueside - Ped Bridge Phasing - Analysis										0.00
2	Blueside - Ped Bridge Phasing - Temp Bracing			8							8.00
3	Blueside - Ped Bridge Phasing - Demizing Wall			4							4.00
4	Blueside - Ped Bridge Phasing - Diaphragm Phasing			4							4.00
5	Blueside - Ped Bridge Phasing - Assemble Calc Package			24							24.00
6	Blueside - Ped Bridge Phasing - OC	2	8								10.00
7	Blueside - Ped Bridge Phasing - Drawing / Revit				10	16					26.00
8											0.00
9											0.00
10											0.00
11											0.00
	Subtotal Hours	2.00	8.00	40.00	10.00	16.00	0.00	0.00	0.00	0.00	76.00
	Rate	\$ 81.25	\$ 60.00	\$ 40.00	\$ 39.00	\$ 28.00	\$ 20.00				
	Subtotal Direct Labor	\$ 162.50	\$ 480.00	\$ 1,600.00	\$ 390.00	\$ 448.00	\$ -	\$ -	\$ -	\$ -	\$ 3,080.50
	Subtotal Burdened Labor @		2.84								\$ 8,748.62

8230 18 MTCE Project
Tampa International Airport

CE 0017

HNTB Architectural

Architectural Design

100% Design Fee

Project Fee Proposal - Hensel Phelps Team											
Main Terminal Curbside Expansion - HNTB Arch											
HCAA Project Number 8230-18											
3/18/2019											
Scope/Task		Arch PM	Arch Des. Dir	Arch Sr. Des.	Arch Sr. PA	Arch Jr. Des.	Tech. Staff		Admin	QC	Total
		Hours	Hours	Hours	Hours	Hours	Hours	Hours	Hours	Hours	Hours
Basic Design Services											
Task - 100% Design											
1	MEP Coordination for 90% Deliverable				8	12					20.00
2	Code Analysis Coordination for 90% Deliverable	8									8.00
3	Drawing Revisions for 90% Deliverable				8	12				2	22.00
4											0.00
5											0.00
6											0.00
7											0.00
8											0.00
9											0.00
10											0.00
11											0.00
Subtotal Hours		8.00	0.00	0.00	16.00	24.00	0.00	0.00	0.00	2.00	50.00
Rate		\$ 70.00	\$ 80.00	\$ 43.50	\$ 46.00	\$ 27.00	\$ 25.00		\$ 35.50	\$ 93.00	
Subtotal Direct Labor		\$ 560.00	\$ -	\$ -	\$ 736.00	\$ 648.00	\$ -	\$ -	\$ -	\$ 186.00	\$ 2,130.00
Subtotal Burdened Labor @			2.84								\$ 6,049.20

8230 18 MTCE Project
Tampa International Airport

CE 0017

HNTB Civil

Civil Design

90% Design Fee

Project Fee Proposal - Hensel Phelps Team												
Main Terminal Curbside Expansion - HNTB Civil												
HCAA Project Number 8230-18												
3/18/2019												
Scope/Task		PM	Chief Eng/Planr	Sr. PE	PE	Eng.	Sr. Des.	Des.	Sr. Tech	Clerical		Total
		Hours	Hours	Hours	Hours	Hours	Hours	Hours	Hours	Hours		
Basic Design Services												
Task - 90% Design												
1	Grading/Roadway Design	1		4	6	6	9	6	3	1		36.00
2	Drainage Design	1	2	5	6	7	3	4	3	1		32.00
3	Bridge Structural Design	4	12	28	37	35	18	22	11	3		170.00
4												0.00
5												0.00
6												0.00
7												0.00
8												0.00
9												0.00
10												0.00
11												0.00
Subtotal Hours		6.00	14.00	37.00	49.00	48.00	30.00	32.00	17.00	5.00		238.00
Rate		\$ 123.85	\$ 91.82	\$ 70.16	\$ 53.40	\$ 44.27	\$ 53.72	\$ 43.26	\$ 27.71	\$ 24.80		
Subtotal Direct Labor		\$ 743.10	\$ 1,285.48	\$ 2,595.92	\$ 2,616.60	\$ 2,124.96	\$ 1,611.60	#####	\$ 471.07	\$ 124.00		\$ 12,957.05
Subtotal Burdened Labor @			2.84									\$ 36,798.02

100% Design Fee

Project Fee Proposal - Hensel Phelps Team											
Main Terminal Curbside Expansion - HNTB Civil											
HCAA Project Number 8230-18											
3/18/2019											
Scope/Task		PM	Chief Eng/Plan	Sr. PE	PE	Eng.	Sr. Des.	Des.	Sr. Tech		Total
		Hours	Hours	Hours	Hours	Hours	Hours	Hours	Hours	Hours	
Basic Design Services											
Task - 100% Design											
1	Grading/Roadway/MOT	1	1	3	4	5	8	2			24.00
2	Drainage Design			3	2	6	4	3	2		20.00
3	Bridge Structural Design	1	4	10	16	8	4	8	3		54.00
4											0.00
5											0.00
6											0.00
7											0.00
8											0.00
9											0.00
10											0.00
11											0.00
	Subtotal Hours	2.00	5.00	16.00	22.00	19.00	16.00	13.00	5.00	0.00	98.00
	Rate	\$ 123.85	\$ 91.82	\$ 70.16	\$ 53.40	\$ 44.27	\$ 53.72	\$ 43.26	\$ 27.71		
	Subtotal Direct Labor	\$ 247.70	\$ 459.10	\$ 1,122.56	\$ 1,174.80	\$ 841.13	\$ 859.52	\$ 562.38	\$ 138.55	\$ -	\$ 5,405.74
	Subtotal Burdened Labor @		2.84								\$ 15,352.30

8230 18 MTCE Project
Tampa International Airport

CE 0017

Henderson Consulting

Code Compliance

100% Design Fee

Project Fee Proposal - Hensel Phelps Team											
Main Terminal Curbside Expansion - Henderson Consulting											
HCAA Project Number 8230-18											
3/18/2019											
Scope/Task		Principal Hours	Director Hours	Sr Code Cons Hours	Code Cons Hours	BIM/CADD Hours	Admin Hours	- Hours	- Hours	- Hours	Total
Basic Design Services											
Task - 100% Design											
1	general code consulting		2	8							10.00
2											0.00
3											0.00
4											0.00
5											0.00
6											0.00
7											0.00
8											0.00
9											0.00
10											0.00
11											0.00
Subtotal Hours		0.00	2.00	8.00	0.00	0.00	0.00	0.00	0.00	0.00	10.00
Rate		\$ 72.16	\$ 60.90	\$ 60.10	\$ 34.00	\$ 18.50	\$ 20.00	\$ -	\$ -	\$ -	
Subtotal Direct Labor		\$ -	\$ 121.80	\$ 480.80	\$ -	\$ -	\$ -	\$ -	\$ -	\$ -	\$ 602.60
Subtotal Burdened Labor @			2.90								\$ 1,747.54

8230 18 MTCE Project
Tampa International Airport

CE 0017

Voltair

Electrical Design

8230 18 MTCE Project
Tampa International Airport

CE 0017

MCE

Structural Design

8230 18 MTCE Project
Tampa International Airport

CE 0017

Selbert Perkins

Signage Design

